

Hull & Engine Room Fittings



SECTION 2

2



2-4	<i>Water Strainers</i>
4-5	<i>Bronze Strainers Skin Fittings & Scoops</i>
6-7	<i>Brass & Chrome Skin Fittings, Gratings & Seawater Strainers</i>
8	<i>Bronze Flanges, Flanged Strainers & Valves</i>
9-22	<i>Anodes</i>
22-27	<i>Impellers</i>
28-29	<i>Shaft Bearings</i>
30-31	<i>PSS Shaft Seals</i>
32	<i>Waterlock/Silencers & Exhaust Hose</i>
33	<i>Exhaust Fittings</i>
34-35	<i>Lubricants & Insulation</i>
36	<i>Fuel Filters & Accessories</i>
37	<i>Greasers & Lubrication</i>
38-39	<i>Deck Fillers & Fittings</i>
40-41	<i>Plastic Fuel Tanks & Accessories</i>
42	<i>Tank Vents & Miscellaneous</i>
43	<i>Tank Senders & Gauges</i>



Five Depots Nationwide

Aquafax Limited, 14 Dencora Way, Sundon Business Park, Luton, Beds LU3 3HP Tel:(01582) 568700 Fax:(01582) 568720
 Aquafax Ltd. (Hamble), 12-13 Mitchell Point, Ensign Business Park, Hamble, Southampton SO31 4RF Tel:(023) 80457206 Fax:(023) 80457208
 Aquafax Ltd. (Plymouth), Unit 5 Plymouth Trade Park, 22 Macadam Road, Plymouth PL4 0RU Tel:(01752) 669944 Fax:(01752) 667764
 Aquafax Ltd. (Middlewich), Unit 11, Valley Court, Sanderson Way, Middlewich, Cheshire CW10 0GF Tel:(01606) 841111 Fax:(01606) 841188
 Aquafax Ltd. (Wroxham), Unit 31 Littlewood Lane, Stalham Road Ind. Estate, Hoveton, Norfolk NR12 8DZ Tel:(01603) 781881 Fax:(01603) 781981



WATER STRAINERS



WATER STRAINER - 'FISHERMAN' MODEL

A top quality engine inlet strainer. Popular with professional boat users due to cap on 3 larger sizes being fitted with wing nuts • Cast in Bronze with inner removable synthetic filter gauze • Perforations 2mm dia.
• Thread: BSP Parallel ISO 228/1 (BS 2779) (DIN 259)

BSP	Size OA approx	Part No.	Spare Gauze & Dimensions	
1/2"	140 x 55mm dia	2-70151	12-70151-4	88 x 25mm OD
3/4"	150 x 57mm dia	2-70152	12-70152-4	114 x 29mm OD
1"	210 x 85mm dia	2-70153	12-70153-4	152 x 38mm OD with wing nut fittings
1 1/4"	250 x 90mm dia	2-70154	12-70154-4	190 x 45mm OD with wing nut fittings
1 1/2"	250 x 90mm dia	2-70155	12-70154-4	190 x 45mm OD with wing nut fittings



WATER STRAINER - 'NORFOLK' MODEL

An inexpensive design with long body possibly allowing cap to be above water line for easy removal and cleaning of synthetic filter gauze. This can be done without need to close valve thus making it popular with hire cruiser operators • Cast in Bronze • Thread: BSP Parallel ISO 228/1 (BS 2779) (DIN 259)

BSP	Size OA approx	Part No.	Spare Gauze & Dimensions	
1/2"	150 x 40mm dia	2-70551	12-70551-4	117 x 32mm OD
3/4"	155 x 40mm dia	2-70552S	12-70551-4	117 x 32mm OD short version
3/4"	220 x 40mm dia	2-70552	12-70552-4	178 x 32mm OD
1"	240 x 42mm dia	2-70553	12-70553-4	197 x 35mm OD
1 1/4"	275 x 50mm dia	2-70554	12-70554-4	230 x 42mm OD
1 1/2"	275 x 50mm dia	2-70555	12-70554-4	230 x 42mm OD

WATER STRAINERS



BULKHEAD MOUNTED WATER STRAINER

- Nickel plated Brass body
- Threaded vertical F/inlet and horizontal F/Outlet
- Top sealed by neoprene O' ring
- AISI 316L S/S filter basket
- Fixing lug on bowl side
- Available with metal, or clear PA6 polyamide top
- Supplied with top removing tool
- Filter perforation 1mm Dia.
- Approved by R.I.N.A. - Copy certificates available

Metal Top	2-70600	2-70610	2-70620
Clear Top	2-70601	2-70611	2-70621
G*/BSP	3/8"	1/2"	3/4"
Weight** (g)	1190 (970)	1160 (940)	1120 (900)
H (mm)	105	105	105
H1 (mm)	62	62	62
L (mm)	99	99	99
A (mm)	20	20	20
B (mm)	20	20	20
Hf (mm)	75	75	75
Df (mm)	49	49	49
Flow Rate @ 0.1 Bar	1800	2550	4750
Flow Rate @ 1 Bar	5750	8180	15160

G* Thread: BSP Parallel ISO 228/1 (BS 2779) (DIN 259)

** Clear Top weights are shown in brackets

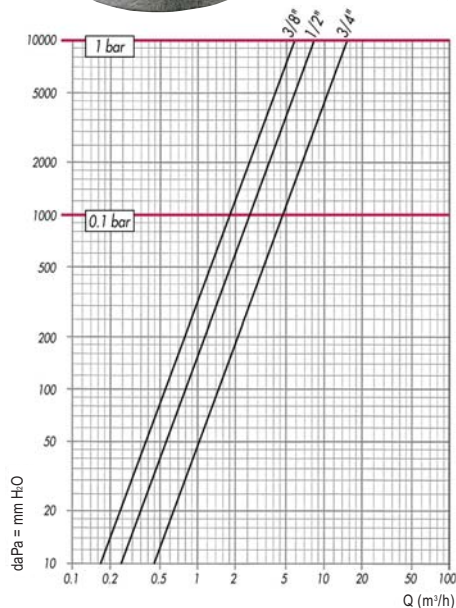

Flow-rate capacity through the clean filter - lt/h



Bulkhead Mounting Bracket in black plastic (optional extra) Part No. 2-70623

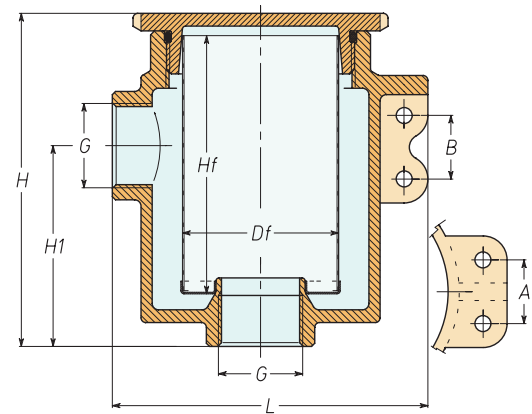



WATER STRAINERS



BULKHEAD MOUNTED WATER STRAINER

- Nickel plated Bronze body
- Thread: BSP Parallel ISO 228/1 (BS 2779) (DIN 259)
- Vertical inlet & horizontal outlet
- AISI 316L S/S filter basket
- Transparent polycarbonate top
- Approved by R.I.N.A. - Copy certificates available
- Solid metal tops available to special order

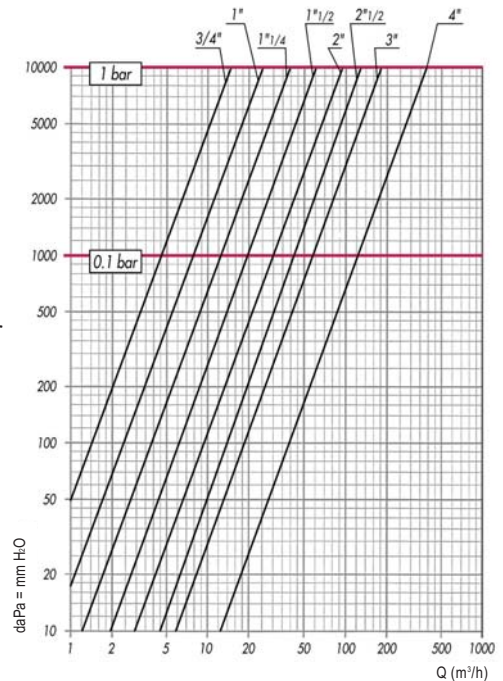

Flow-rate capacity through the clean filter – l/h



**METAL TOP
TO ORDER ONLY**

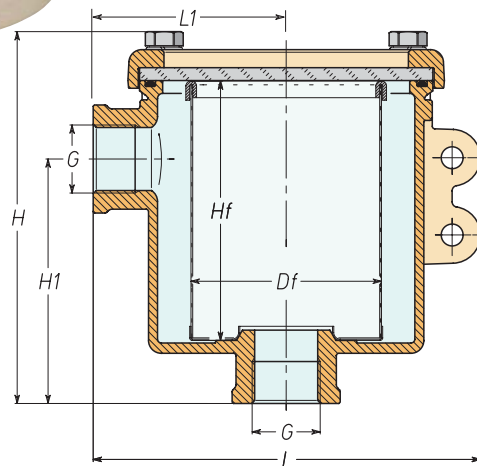

Clear Top	2-70652	2-70653	2-70654	2-70655	2-70656	2-70657	2-70658	2-70659*
G*/BSP	3/4"	1"	1 1/4"	1 1/2"	2"	2 1/2"	3"	4"
Weight** (g)	2730 (3000)	2600 (2870)	4000 (4550)	3800 (4350)	6200 (6700)	9000 (10200)	9600 (10800)	14600
C (mm)	30	30	40	40	50	60	80	100
H (mm)	144	144	178	178	215	243	276	326
H1 (mm)	97	97	103	103	135	150	177	211
L1 (mm)	76	76	91	91	106	126	129	142
L (mm)	151	151	180	180	213	252	255	277
Hf (mm)	100	100	131	131	160	188	215	260
Df (mm)	74	74	98	98	124	155	155	165
Flow Rate @ 0.1Bar	4650	7950	12500	19100	30000	42600	58400	123000
Flow Rate @ 1Bar	14900	25500	40100	61250	96200	134000	184000	390000

G* Thread: BSP Parallel ISO 228/1 (BS 2779) (DIN 259) ** Solid Top weights are shown in brackets

***TO ORDER ONLY**

BRACKETS

- For bulkhead fixing of strainers
- 304 S/Steel 'L' shaped
- Drilled C/W S/Steel fasteners for attaching to strainer (2 brackets for strainers 2-70654 to 2-70658)
- Alternative S/S brackets available for 2-70656 & 2-70657/8 Strainers

Part No.	To fit strainers
2-70683P	Strainers 2-70652/3
2-70685P	Strainers 2-70654/5
2-70686P	Strainers 2-70656
2-70687P	Strainers 2-70657/8

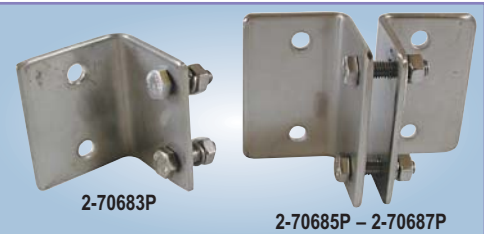

SPARES (Only for water strainers)

Strainer	2-70652	2-70653	2-70654	2-70655	2-70656	2-70657	2-70658
Metal Top	12-70720-1	12-70720-1	12-70740-1	12-70740-1	12-70760-1	12-70770-1	12-70770-1
Lexan Clear Top	12-70720-2	12-70720-2	12-70740-2	12-70740-2	12-70760-2	12-70657-2	12-70657-2
'O' Ring	12-70720-3	12-70720-3	12-70740-3	12-70740-3	12-70760-3	12-70657-3	12-70657-3
Filter Basket	12-70652-4	12-70652-4	12-70654-4	12-70654-4	12-70656-4	12-70657-4	12-70658-4
U' Profile	12-70652-5	12-70653-5	12-70654-5	12-70655-5	12-70656-5	12-70657-5	12-70657-5
Cover Retainer	12-70720-6	12-70720-6	12-70740-6	12-70740-6	12-70760-6	12-70658-6	12-70658-6

**G* Thread: BSP Parallel ISO 228/1
(BS 2779) (DIN 259)**



GUIDI WATER STRAINERS



DECK MOUNTED WATER STRAINERS

A truly well designed and engineered range of free standing strainers.

- Nickel plated Bronze body
- Neoprene 'O' ring
- AISI 316L S/S filter fitted with handle for removing
- Lexan Polycarbonate clear top - withstands max 120°C
- Secured by 4 S/S bolt fixing
- Horizontal BSP F/Thread inlet and outlet
- Base lug fixing and drain plug
- Approved by R.I.N.A. Copy certificates available
- Solid metal top models available to special order

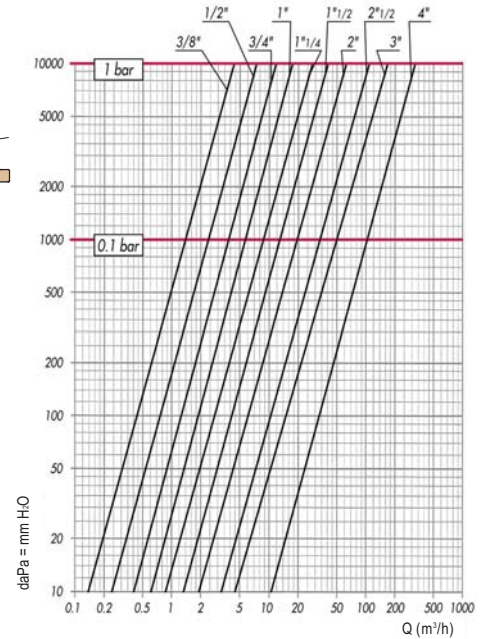
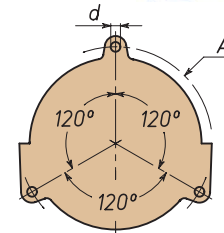
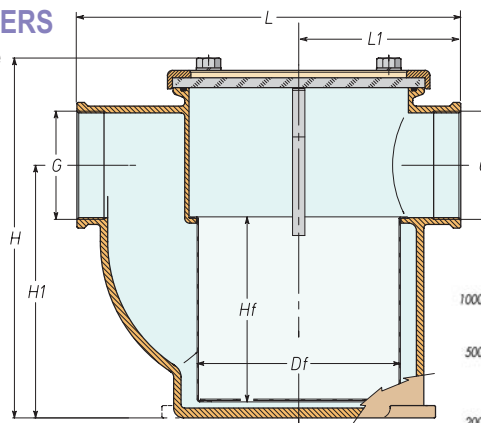

FULL RANGE OF SPARES STOCKED

Part No.	2-70701	2-70711	2-70721	2-70731	2-70741	2-70751	2-70761	2-70771	2-70781	2-70791
G*/BSP	3/8"	1/2"	3/4"	1"	1 1/4"	1 1/2"	2"	2 1/2"	3"	4"
Clear Top Weight (g)	1820	1800	3800	3700	4600	5500	7800	11000	15800	21200
Solid Top Weight (g)	1870	1850	4000	3900	5000	6000	8200	11500	16500	22400
d (mm)	5	5	6.5	6.5	6.5	6.5	8.5	8.5	8.5	8.5
A (mm)	94	94	132	132	150	155	180	180	225	230
H (mm)	117	117	151	151	176	193	216	284	292	355
H1 (mm)	82	82	106	106	122	135	149	210	205	256
L1 (mm)	53	53	77	77	83	88	104	109	131	145
L (mm)	122	122	169	169	184	202	242	260	309	340
Hf (mm)	64	64	77	77	95	100	108	175	151	210
Df (mm)	57	57	87	87	98	105	124	124	165	165
Flow Rate @ 0.1 Bar	1400	2400	3800	5700	8800	12800	19900	33900	50000	103000
Flow Rate @ 1 Bar	4300	7500	12000	17900	27700	40600	63000	107300	166730	326000

G* Thread: BSP Parallel ISO 228/1 (BS 2779) (DIN 259)

ALSO AVAILABLE IN ANODISED ALUMINIUM TO ORDER

GUIDI BRONZE FITTINGS



BRONZE HI-FLOW SCOOP STRAINER

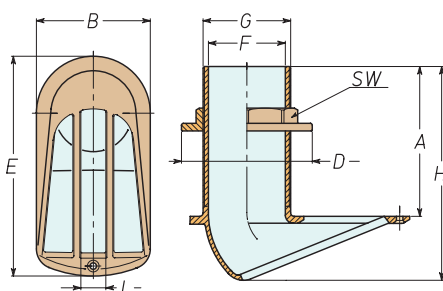
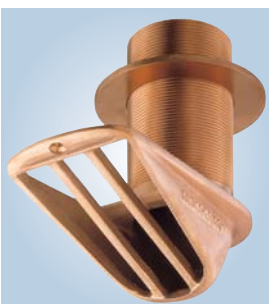

- Designed to provide a high water flow
- Recommended by German Engine Manufacturers

G*/BSP	SW	H	A	F	D	L	E	B	Part No
1"	41	121	90	25	58	10	105	52	2-70273
1 1/2"	49	131	95	33	68	13	125	62	2-70274
1 1/2"	56	140	100	38	76	13	138	69	2-70275
2"	69	157	110	49	90	17	166	82	2-70276
2 1/2"	85	189	130	64	110	21	200	100	2-70277
3"	100	214	150	77	122	25	220	115	2-70278
4"	129	285	200	101	150	32	293	145	2-70279

G* Thread: BSP Parallel ISO 228/1 (BS 2779) (DIN 259)



GUIDI BRONZE FITTINGS



Material: Bronze UNI 7013/8 G-CuSn5Zn5Pb5 *This material is frequently referred to as LG2 Gunmetal*

BRONZE SKIN FITTINGS & SCOOPS

Guidi have made a range of skin fittings in Bronze that can either be used on their own or with a Bronze scoop into which they fit perfectly. The skin fittings have internal lugs for securing. The scoop is held in place by 4 screws.

The removable scoop is a recommendation of ISO 9093 - 1:1994 so seacocks can be cleared easier of obstructions.

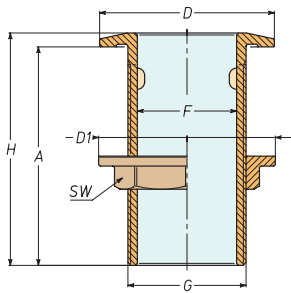

BRONZE SKIN FITTING

G*/BSP	SW	H	D	D1	A	F	Part No.
1/2"	26	70	40	40	65	13	2-70251
3/4"	32	75	47	46	70	19	2-70252
1"	41	85	57	58	80	25	2-70253
1 1/4"	49	91	67	68	85	32	2-70254
1 1/2"	56	96	75	76	90	38	2-70255
2"	69	107	88	90	100	50	2-70256
2 1/2"	85	128	108	110	120	63	2-70257
3"	100	158	122	122	150	76	2-70258
4"	129	209	150	150	200	100	2-70259

SCOOP TO FIT SKIN FITTING

G*/BSP	D	H	B	E	L	Part No.
1/2"	41	21	50	87	4	2-70261
3/4"	48	25	57	105	4	2-70262
1"	58	30	68	123	4	2-70263
1 1/4"	68	35	80	137	5	2-70264
1 1/2"	76	40	92	158	5	2-70265
2"	90	52	108	189	5	2-70266
2 1/2"	110	59	128	221	4	2-70267
3"	124	65	142	235	5.5	2-70268
4"	152	95	182	340	6	2-70269

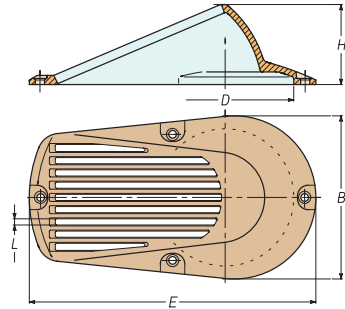

5" & 6" VERSIONS TO ORDER ONLY

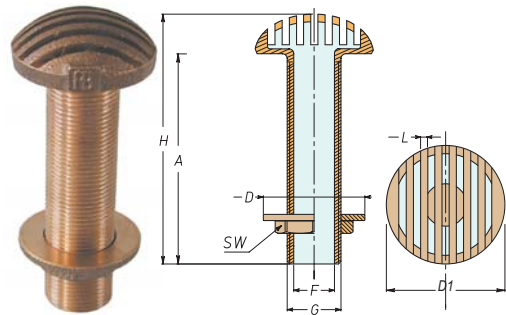

BRONZE GRATED SKIN FITTING

Ideal for toilet, generator & air conditioning units.

G*/BSP	SW	H	A	F	D1	L	D	Part No.
3/4"	32	118	100	19	46	4	51	2-70242
1"	41	121	100	25	58	4	61	2-70243

**See Section 1
for Valves &
Hose
Connectors**



BRONZE SKIN FITTINGS

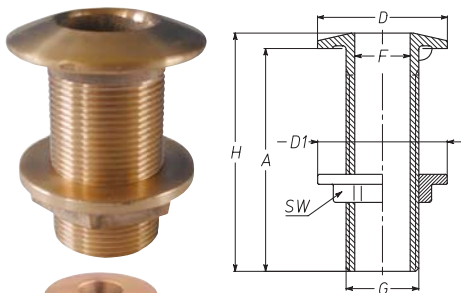

BRONZE SKIN FITTINGS

- Traditional pattern cast in Bronze
- Fitted with matching backnut
- Both heavy duty castings with wide flange nut & anti-rotation nib up to 1 1/2"
- Excellent corrosion resistance

We recommend for use when valves and strainers are coupled together due to their robustness.

G*/BSP	H	D	D1	A	F	Part No.
1/2"	55	40	39	50	13	2-70101
3/4"	70	49	51	64	19	2-70102
1"	75	57	59	68	25	2-70103
1 1/4"	82	67	63	74	31	2-70104
1 1/2"	88	78	74	80	31	2-70105
2"	98	85	89	90	50	2-70106
2 1/2"	120	120	105	112	62	2-70107
3"	144	140	123	134	75	2-70108
4"	144	175	170	134	100	2-70109

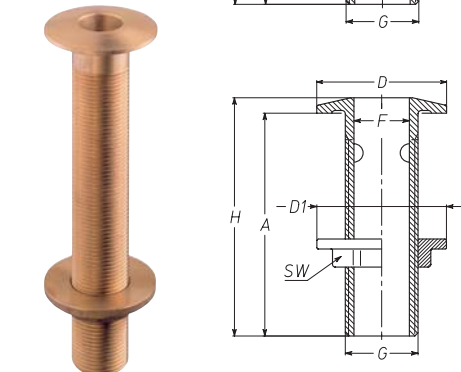

BRONZE SKIN FITTINGS (COMMERCIAL)

- Suitable for thick wooden hulls and bulkheads
- Cast in Bronze
- Fitted with external anti-rotation nibs on flange (except 5" and 6")
- Fitted with heavy duty back nut.

G*/BSP	H	D	D1	A	F	Part No.
3/4"	173	52	50	163	18	2-70112
1"	188	63	54	180	24	2-70113
1 1/4"	190	72	62	182	32	2-70114
1 1/2"	190	85	71	184	37	2-70115
2"	200	100	90	185	48	2-70116
2 1/2"	260	120	98	247	63	2-70117
3"	265	130	128	250	75	2-70118
4"	290	160	155	270	96	2-70119
5"	320	190	180	290	120	2-70120*
6"	350	220	210	310	145	2-70121*

***TO ORDER ONLY**

**G* Thread: BSP Parallel ISO 228/1
(BS 2779) (DIN 259)**



GUIDI BRASS SKIN FITTINGS & GRATINGS

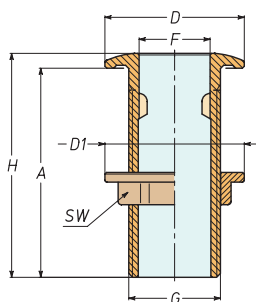

BUDGET SKIN FITTINGS

- Budget priced skin fittings
- Hot stamped in Brass
- Supplied with L/W backnuts.

Whilst valves can be fitted we would recommend the fittings below.

G*/BSP	H	D	D1	A	F	Part No.
3/8"	54	30	30	50	12	2-70000
1/2"	65	35	36	61	15	2-70001
3/4"	70	40	40	65	20	2-70002
1"	75	50	50	70	25	2-70003
1 1/4"	75	60	59	70	34	2-70004
1 1/2"	76	66	66	70	39	2-70005
2"	76	82	82	70	50	2-70006

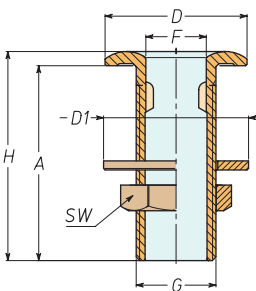

POPULAR SKIN FITTINGS

- A strong fitting shell moulded in Brass
- Fitted with internal securing lugs
- Supplied with large washer and hexagon nut

* Certain sizes available with external anti rotation nib. Ask for details

CHROME FITTINGS

- Up to 2" BSP only.

Add C to part number i.e. 2-70009C



G*/BSP	H	D	D1	A	F	Part No.
1/4"	62	22	22	58	8	2-70008
3/8"	57	34	33	53	12	2-70009
1/2"	65	37	38	60	15	2-70010*
3/4"	70	47	48	65	20	2-70020*
1"	85	55	55	80	25	2-70030*
1 1/4"	86	64	64	80	33	2-70040*
1 1/2"	96	72	72	90	39	2-70050
2"	107	85	88	100	50	2-70060
2 1/2"	130	110	112	122	63	2-70070
3"	158	122	124	150	76	2-70080
4"	209	150	150	200	100	2-70090

SKIN FITTINGS

These fittings are not all from same source, so material and finish varies.

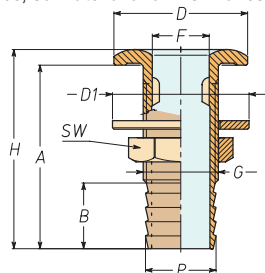

G*/BSP	H	D	D1	A	F	B	P	Material /Finish	Self Colour Part No.	Chrome Plate Part No.
3/8"	57	34	33	53	12	18	15	Brass	2-70315	2-70415
3/4"	90	44	39	85	20	35	19	DZR	2-70319*	2-70419
1"	93	54	44	88	27	32	25	DZR	2-70325*	2-70425
1 1/4"	94	64	55	88	33	35	31	DZR	2-70332*	2-70432
1 1/2"	102	72	65	97	39	35	38	DZR	2-70338*	2-70438
1 1/2"	96	72	72	90	39	27	45	Brass	2-70345	2-70445
2"	120	93	88	110	48	33	51	Bronze	2-70351	-

* = Polished Flange

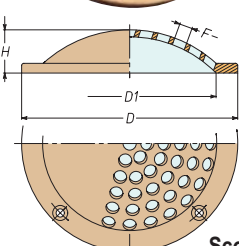
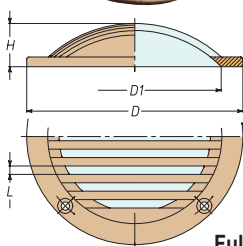

Full

Scoop

GRATINGS

- Shell moulded in Brass
- 4 c/sk hole fixing
- Thickness approx. 4mm

For Skin Fittings	H	L	F	D1	D	Full Grate Part No.	Scoop Grate Part No.
3/8"	10	4	5	33	60	2-70280	2-70290
1/2" - 3/4"	15	4	6	54	80	2-70281	2-70291
1" - 1 1/4"	21	4	6	73	100	2-70282	2-70292
1 1/2" - 2"	27	4	7	96	120	2-70283	2-70293
2"	35	4	7	121	150	2-70284	2-70294

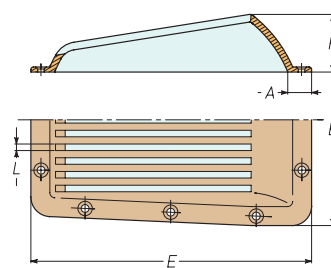

RECTANGULAR SCOOP GRATING

- Cast in Brass
- Thickness 6mm

For Skin Fittings	A	H	L	E	B	Rectangular Part No.
2 1/2"	19	40	4	220	150	2-70289
3"	20	45	5	224	168	2-70295
4"	20	52	5.5	266	200	2-70296

VENT/DRAIN

Chromed brass c/w back nut

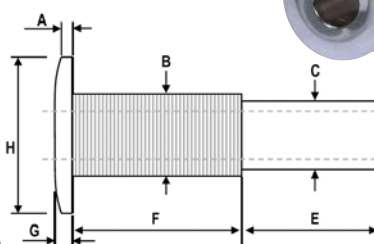

Part No. 2-68081

A	2mm
B	3/8" BSP
C	13mm
D	9.5mm
E	20mm
F	18mm
G	3mm
H	24mm



GUIDI BRASS SEAWATER STRAINERS & BONDING RING

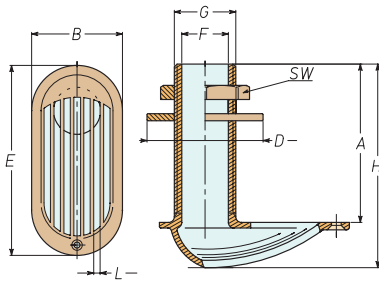

SCOOP STRAINER

- Water inlet with integral scoop and slotted strainer
- Supplied with hexagon nut and large washer
- Shell moulded in Brass



G*/BSP	H	A	D	E	F	L	B	Part No.
3/8"	94	71	33	81	11	2.5	45	2-70200
1/2"	103	76	38	89	14	2.5	52	2-70201
3/4"	102	76	48	106	19	3	59	2-70202
1"	104	76	55	118	25	3	60	2-70203
1 1/4"	118	89	64	123	32	3	65	2-70204
1 1/2"	119	88	72	134	37	3	72	2-70205
2"	136	99	88	160	48	3	85	2-70206

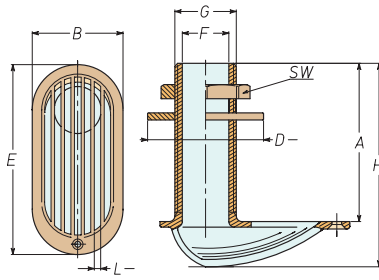

GRATED SKIN FITTING

- With full length slots to stop scoop effect.
- Shell moulded in Brass
- Supplied with hexagon nut and large washer
- Applications: Inlets for toilets, air conditioning units, generators, etc.



G*/BSP	H	A	D	E	F	L	B	Part No.
1/2"	103	76	38	89	14	2.5	52	2-70211
3/4"	102	76	48	106	19	3	59	2-70212
1"	104	76	55	118	25	3	60	2-70213
1 1/4"	118	89	64	123	32	3	65	2-70214

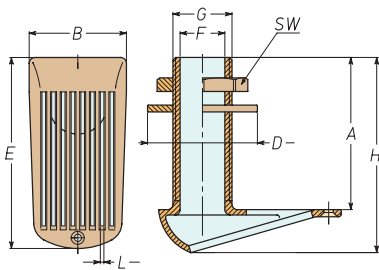

HIGH PERFORMANCE SCOOP STRAINER

- The wedge shape scoops more water which with high speed powerboat engines is necessary.
- Alignment is easy with front fastener hole
- Shell moulded in Brass
- Supplied with large washer and hexagon nut



G*/BSP	H	A	D	E	F	L	B	Part No.
1/2"	101	80	38	78	15	4	44	2-70231
3/4"	102	80	48	89	20	4	48	2-70232
1"	110	85	55	101	25	4	55	2-70233
1 1/4"	116	90	64	118	33	4	64	2-70234
1 1/2"	129	100	72	132	38	4	73	2-70235
2"	143	110	88	160	49	4	85	2-70236

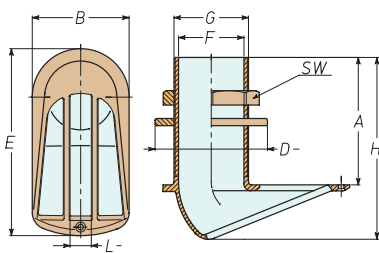

HI-FLOW SCOOP STRAINER

- Designed in co-operation with the UK's leading powerboat builders to provide a high water flow.
- Shell moulded in Brass



G*/BSP	H	A	D	E	F	L	B	Part No.
2 1/2"	189	130	112	200	64	21	100	2-70247
3"	214	150	124	220	77	25	115	2-70248
4"	285	200	150	293	101	32	145	2-70249

BRASS BONDING RING WITH CABLE CONNECTION

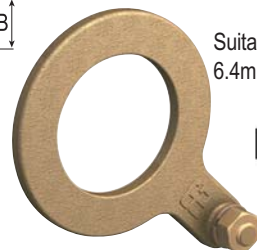
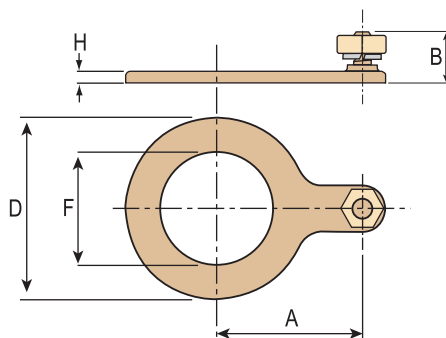

Suitable for use with 6.4mm ring terminals

For ring terminals & cable see Section 8

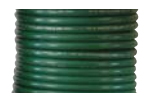

Size	H	A	B	F	D	Part No.
3/4"	3.5	41	23.5	28	48	2-70482
1"	3.5	44	23.5	34	55	2-70483
1 1/4"	4.5	49	24.5	43	64	2-70484
1 1/2"	5	53	25	49	72	2-70485
2"	5.5	61	25.5	60.5	88	2-70486
2 1/2"	6	73	26	76	112	2-70487
3"	6	79	26	89	124	2-70488
4"	6	92	26	115	150	2-70489

G* Thread: BSP Parallel ISO 228/1 (BS 2779) (DIN 259)

GUIDI BRONZE FITTINGS



PN16 FLANGE WITH FEMALE OR MALE THREAD • Bronze 16 Bar • G** Thread: BSP Taper ISO 7/1 (BS21)

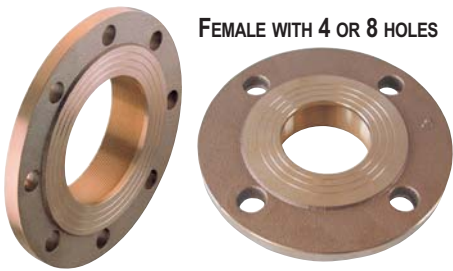

FEMALE WITH 4 OR 8 HOLES

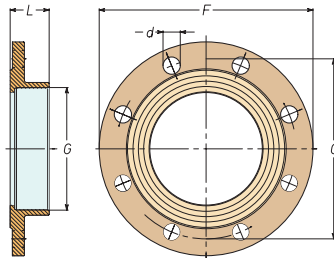

G**	Holes	L	d	C	F	DN	Part No.
1 1/4"	4	29	19	100	140	32	2-78102
1 1/2"	4	29	19	110	150	40	2-78112
2"	4	34	19	125	165	50	2-78122
2 1/2"	4	38	19	145	185	65	2-78132*
3"	8	42	19	160	200	80	2-78142
4"	8	49	19	180	220	100	2-78152
5"	8	52	19	210	250	125	2-78162*
6"	8	53	23	240	285	150	2-78172*



MALE WITH 4 OR 8 HOLES

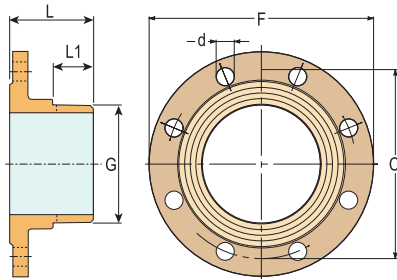

G**	Holes	L	L1	d	C	F	DN	Part No.
1 1/4"	4	57	22	18	100	140	32	2-78103*
1 1/2"	4	58	23	18	110	150	40	2-78113*
2"	4	62	26	18	125	165	50	2-78123*
2 1/2"	4	69	30	18	145	185	65	2-78133*
3"	8	74	33	18	160	200	80	2-78143*
4"	8	81	39	18	180	220	100	2-78153*
5"	8	89	44	18	210	250	125	2-78163*
6"	8	91	44	22	240	285	150	2-78173*

GASKETS TO SUIT AVAILABLE TO ORDER

*TO ORDER ONLY

LARGE FLANGED BRONZE VALVES FULL SPECIFICATION AVAILABLE ON REQUEST



GATE VALVES
11-7020+ Range

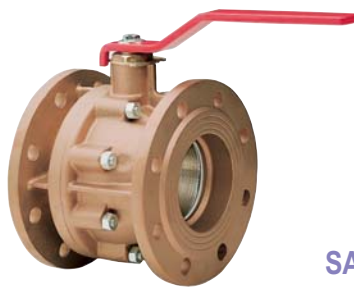

BALL VALVES
11-7030+ Range



SAFETY INTAKE "NON-STICK" VALVES
Flanged and threaded versions available.
12-7100+ Range



DOUBLE INTAKE VALVES
Flanged and threaded versions available.
12-7102+ Range

HEAVY DUTY BRONZE FLANGED SEAWATER STRAINERS

FULL SPECIFICATION AVAILABLE ON REQUEST. ALSO AVAILABLE IN ANODISED ALUMINIUM.



VERTICAL INTAKE
6" Bore DN150 90°
Part No. 2-70806



HORIZONTAL INTAKE
6" Bore DN150
Part No. 2-70796

BLAKES POPULAR PLUS SEACOCK

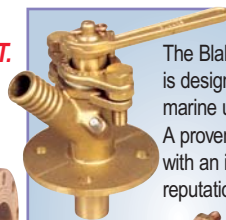

The Blakes Seacock is designed for marine use. A proven design with an international reputation.

- Stainless steel grease nipple for in water maintenance
- Positive on / off handle
- Left or right hand operation
- Suitable for GRP, steel, wood & ferrocement hulls
- Available in 3/4" and 1 1/2" hose sizes
- Complete with fixing bolts (3/4" has strainer plate)
- Seacock material: DZR Brass (Lloyds approved)

Specification:

	3/4" (19mm)	1 1/2" (38mm)
Outlet:	3/4" (19mm)	1 1/2" (38mm)
Seacock Material:	DZR	DZR
Bolt Material:	Bronze	Bronze
Nut material (for bolt):	DZR locknut or Bronze	
OA height:	94mm	118mm
OA width (inc lever):	147mm	203mm
Max hull thickness:	37mm	36mm
Flange dia.:	83mm	95mm
Hole (.4) centres:	61mm	73mm
Part No.	2-71162	2-71165

BLAKES SEACOCK GREASE
Synthetic, good adhesion and water resistant. Weight approx 500g Part No. 2-71168



ZINC AND ALUMINIUM ANODES

**TOP QUALITY BRITISH MADE ANODES
AT VERY COMPETITIVE PRICES**

Specifications:	Zinc Anodes - MIL-18001
	Aluminium Anodes - MIL-A-24779
	Magnesium Anodes - Magnesium Alloy high purity BS: HG63

PIRANHA BOLT ON STRAIGHT ANODE

FOR SEAWATER APPLICATIONS



Material:	Zinc	Aluminium*
Weight:	4kg	1.7kg
Part No.	2-26070	2-26070A

Backing pad Part No.: 2-26170

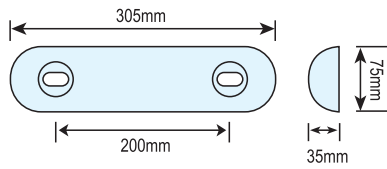

Material:	Zinc
Weight:	7kg
Part No.	2-26071

Backing pad Part No.: 2-26172

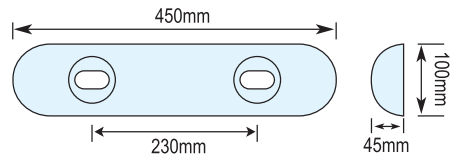

Material:	Zinc	Aluminium*
Weight:	12kg	5kg
Part No.	2-26072	2-26072A

Backing pad Part No.: 2-26172

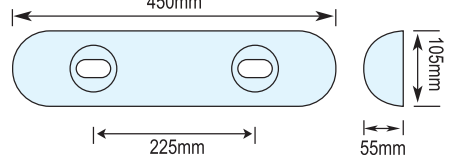

PIRANHA DISC ANODES

FOR SEAWATER APPLICATIONS

Material:	Zinc
Size:	70mm
Weight:	0.7kg
Part No.	2-26051

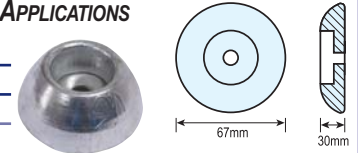

Material:	Zinc	Aluminium*
Size:	100mm	100mm
Weight:	1kg	0.4kg
Part No.	2-26056	2-26056A

Backing Pad Part no. 2-26156

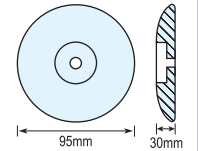

Material:	Zinc	Aluminium*
Size:	150mm	150mm
Weight:	2.2kg	0.8kg
Part No.	2-26058	2-26058A

Backing Pad Part no. 2-26158

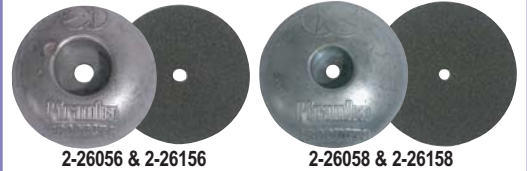
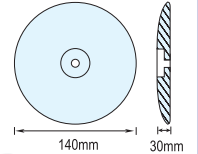

PIRANHA BOLT ON PEAR ANODE

FOR SEAWATER APPLICATIONS



Material:	Zinc
Weight:	2.1kg
Part No.	2-26077

Material:	Aluminium*
Weight:	1kg
Part No.	2-26077A

Backing pad Part no. 2-26177

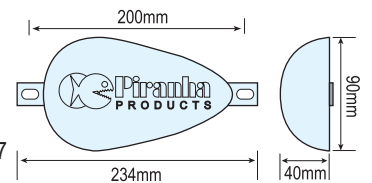

PIRANHA WELD-ON ANODE

NEW

**FOR HULL PROTECTION ON
STEEL BOATS IN SEAWATER,
BRACKISH WATER &
FRESHWATER**



Material:	Zinc
Weight:	8.5kg
Part No.	2-26080

Material:	Aluminium*
Weight:	4kg
Part No.	2-26080A

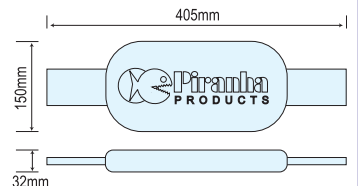

*Piranha Aluminium Anodes Available Soon

MAGNESIUM ANODES

MAGNESIUM ANODES (BOLT ON)

FOR FRESH WATER APPLICATIONS

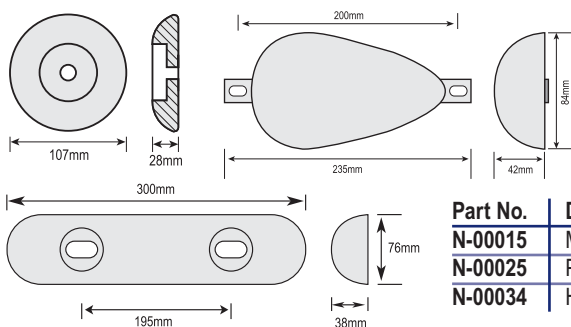

Please Note: Magnesium anodes are lighter size for size than the equivalent shaped in zinc, however the same backing pads may be used.

Part No.	Description	Weight
N-00015	M56 Button Anode	0.28kg
N-00025	Pear Anode	0.68kg
N-00034	Hull Anode	1.0kg



MAGNESIUM ANODES (WELD ON)

FOR FRESH WATER APPLICATIONS

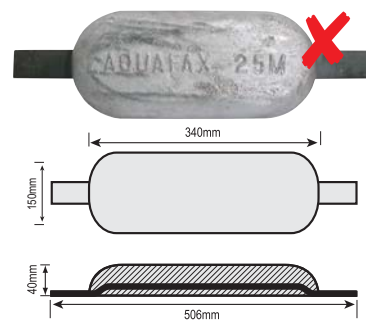

Part No.	Description	Weight
N-00002	300 x 90 x 45mm	1.5kg
N-00004	335 x 150 x 35mm	2.5kg
N-00007	410 x 115 x 75mm	4.0kg

DELIVERY
Unable to send via carriers. Please contact your local Aquafax sales depot for method and price of despatch.

Performance Metals Aluminium Anodes



Aquafax

ANODES



THE ONLY ANODES WITH THE WEAR INDICATOR

Performance Metals Aluminium Anodes feature patent pending "Wear Indicator" which tell the boater when it's time to change. This plastic indicator is embedded in the anode and appears in the surface of the anode when it wears.

- Aluminium/Indium alloy is more active so it gives better protection
- Essential for Mercury sterndrives - Zinc will not provide the correct protection
- Recommended for both salt and freshwater on Mercury sterndrives
- Last up to 50% longer than zinc anodes
- Aluminum anodes "self-clean" in freshwater - Zinc anodes form a coating that stops them working within a few months
- Environmentally friendly
- Mounting hardware included
- Attractively packaged with clear information to aid with selection and installation - reducing the need for trained store staff

Alloy meets military specification MIL-A-24779 (SH)

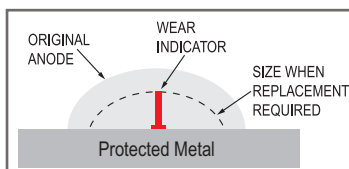

SACRIFICIAL ANODE MATERIALS - COMPARISON

	Zinc	Aluminium	Magnesium
Voltage (in seawater)	-1.03V	-1.1V	-1.5V
Relative Life (zinc = 100 same size)	100	150	30
Relative Density (zinc = 100)	100	42	27
Military Specification	MIL-A-18001	MIL-A-24779	MIL-A-21412

WHICH ANODE MATERIAL?

	Inboard			Outdrive	
Hull Material	Wood	Fibreglass	Aluminium	Steel	All
Freshwater (Pure)	Alum	Alum/Mag	Alum	Alum/Mag	Alum/Mag
Freshwater (Polluted)	Alum	Alum	Alum	Alum	Alum
Brackish	Alum/Zinc	Alum/Zinc	Alum/Zinc	Alum/Zinc	Alum
Salt	Alum/Zinc	Alum/Zinc	Alum/Zinc	Alum/Zinc	Alum



HULL & STRAINER ANODES

Description	Dimensions	Part No.
Mini Driver	152 x 102 x 13	2-24400A
Driver	305 x 152 x 13	2-24401A
Hull Plate	220 x 108 x 25	2-24404A
Hull Plate	235 x 86 x 20	2-24406A
Doka Strainer	83 x 32 x 13	2-24410A
Bosler Strainer	-	2-24411A
Bennett Trim Tab Kit	-	2-24415A
Hull Plate	120 x 50 x 20	2-24424A
Hull Plate	235 x 86 x 20	2-24425A
Hull Plate	160 x 70 x 16	2-24430A
Hull Plate	190 x 70 x 13	2-24440A
Hull Plate	146 x 64 x 20	2-24442A
Hull Plate	160 x 70 x 20	2-24443A
Hull Plate	203 x 102 x 20	2-24445A
Transom Fin 2.6kg	305 x 153 x 40	2-24460A

BOLT-ON PEAR ANODE



LxWxH: 250 x 88 x 43mm Part No. 2-60377A

VOLVO ANODES & KITS

Anodes

Item	Series	Part No.
Collar	100	2-60700A
Collar	200	2-60701A
Collar	250/270/275	2-60702A
Collar	280	2-60703A
Collar	290	2-60704A
Collar	110	2-60705A
Bar	280 Duo Prop	2-60707A
Bar	Duo Prop	2-60708A
Plate	290 Duo Prop	2-60717A
Plate	S Drive	2-60718A
Plate	DPX	2-60724A
Plate	Penta	2-60726A



Kits

Description	Part No.
280 Kit	2-24274A
280 Duo Prop Kit	2-24275A
290 Kit	2-24276A
290 Duo Prop Kit	2-24277A
SX Kit	2-24278A



FLANGE ANODES

Description	Dia.	Part No.
Flange	48mm	2-60100A
Flange	72mm	2-60101A
Flange	95mm	2-60102A
Flange	127mm	2-60104A

Supplied as a pair with single bolt through fixing



ANODES



2-24002A



2-60816A



2-24195A

2-60801A



2-60163A



2-60268A



2-60814A

2-60807A



2-60806A

2-60807A

2-60815A



2-60817A

2-60818A



2-60819A



2-60820A



2-60825A



2-60828A

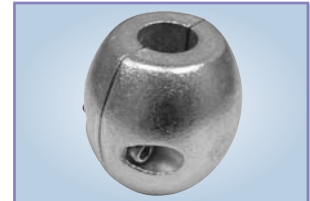

SHAFT ANODES

Item	Size	Part No.
Shaft	3/4"	2-60500A
Shaft	7/8"	2-60501A
Shaft	25mm	2-60502A
Shaft	1"	2-60503A
Shaft	1 1/8"	2-60505A
Shaft	30mm	2-60506A
Shaft	1 1/4"	2-60507A
Shaft	35mm	2-60509A
Shaft	1 1/2"	2-60510A
Shaft	40mm	2-60511A
Shaft	1 3/4"	2-60512A
Shaft	50mm	2-60513A
Shaft	2"	2-60514A
Shaft	2 1/4"	2-60516A
Shaft	2 1/2"	2-60518A

MERCURISER ANODES

Description	Part No.
Kit Verado 4	2-24002A
Kit Bravo Prop	2-24195A
Prop Nut Anode Bravo 3	2-60163A
Trim Tab Flat	2-60268A
Engine Fin Trim	2-60801A
Engine G.H. Block Plate	2-60806A
Engine Nut	2-60807A
Cavitation Plate Alpha 1	2-60814A
Engine Cavitation Plate Bravo 40/60 HP	2-60816A
Drive Trim Cyl Mercruiser Alpha 1	2-60817A
Drive Trim Cyl Mercruiser Bravo	2-60818A
Bearing Carrier Mercruiser Alpha	2-60819A
Trim Fin Flat Mercruiser Bravo	2-60820A
Plate Anode	2-60825A
Bearing Carrier Mercruiser Bravo	2-60828A

COLLAR ANODES

Item	Shaft	Part No.
Collar	3/4"	2-60550A
Collar	7/8"	2-60551A
Collar	1"	2-60553A
Collar	1 1/8"	2-60554A
Collar	1 1/4"	2-60556A

COMPLETE MERCURY OUTDRIVE KITS



2-24008A



2-24059A



2-24060A



2-24061A

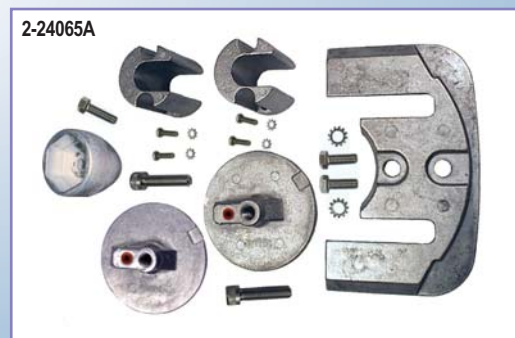

2-24065A

Description	Part No.
Drive Kit Alpha Gen 1	2-24008A
Drive Kit Alpha Gen 2	2-24059A
Drive Kit Bravo 1	2-24060A
Drive Kit Bravo 2 & 3 (to 2003)	2-24061A
Drive Kit Bravo 3 "New 2004"	2-24065A

Alloy meets military specification MIL-A-24779 (SH)



TECNOSEAL ANODES



ZINC ANODES FOR FLANGE

Part No:	Ø	Ø1	Ø2	h	kg
2-60100	50	21	7	15	0.130
2-60101	70	22	8.5	16	0.270
2-60102	90	27	9	20	0.510
2-60103	110	30	12	21	0.850
2-60104	125	30	11	26	1.300
2-60105	140	31	12	33	2.000
2-60106	190	35	13	27	3.800

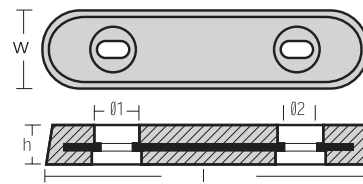
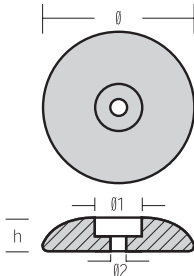

ZINC HULL ANODES (Bolt Through)

Part No:	l	w	h	i	kg	Ø1	Ø2
2-60220	150	60	25	80	0.9	27	11x15
2-60221	240	65	29	140	2.3	32	13x25
2-60222	290	55	30	200	2.7	32	13x25
2-60223	350	72	35	200	4.5	38	13x25

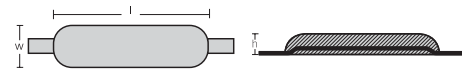

ZINC HULL ANODES (Weld On)

Part No:	l	w	h	OV	Strap	kg
2-60301	110	63	26	1	200x25x5	1.0
2-60302	200	70	25	1.8	300x25x5	1.8
2-60303	215	70	29	2.2	300x25x5	2.2
2-60304	200	90	35	3	300x25x5	3.0

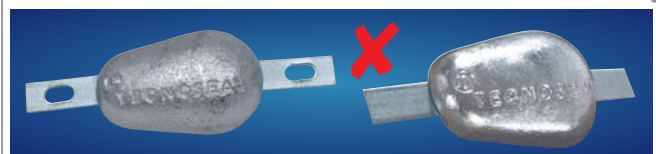

ZINC PEAR SHAPED ANODES

Part No:	l	w	h	i	Strap	kg	Type
2-60340	120	80	25	200	250x25x5	1.0	Bolt on
2-60341	140	90	35	205	250x25x5	1.8	Bolt on
2-60342	165	100	42	200	250x25x5	3.0	Bolt on
2-60377	135	90	35	200	255x25x5	2.1	Bolt on
2-60350	120	80	25	-	230x25x5	1.0	Weld on
2-60351	140	90	35	-	250x25x5	1.8	Weld on
2-60352	165	100	42	-	250x25x5	3.0	Weld on



SINGLE ANODE FIXING SETS

- 2-60080 M5 Shaft Anode Fixing Screw
- 2-60081 M6 Shaft Anode Fixing Screw
- 2-60090 10mm Fixing Bolt Complete
- 2-60091 16mm Fixing Bolt Complete
- 2-60095 10mm Weld-on Fixing Stud Set
- 2-60096 16mm Weld-on Fixing Stud Set



ZINC SHAFT ANODE

Part No.	ØID
2-60500	19mm (¾")
2-60501	22mm (⅞")
2-60502	25mm
2-60503	25.4mm (1")
2-60505	28.6mm (1½")
2-60506	30mm
2-60507	31.8mm (1¼")
2-60509	35mm (1⅜")
2-60510	38mm (1½")
2-60511	40mm
2-60511M	44.4mm (1⅜")
2-60512	45mm
2-60513	50mm
2-60514	50.8mm (2")
2-60516	57.1mm (2¼")
2-60518	63.5mm (2½")

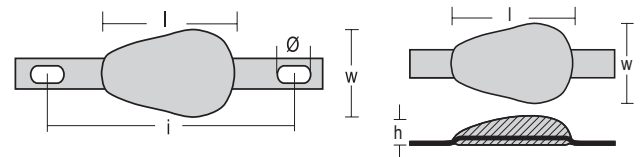

ZINC CONE NUT ANODE

2-60445	¾"W	Ø38	h66
2-60454	1"W	Ø52	h80

Other sizes available on request

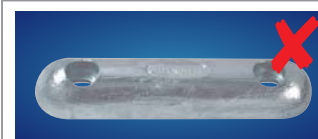

FAIRLINE BOLT-ON ANODES

Part No.	Size (LxWxH)	kg
2-60270E	320 x 65 x 35	2.2
2-60271E	310 x 75 x 40	4.0
2-60272E	455 x 90 x 40	7.0

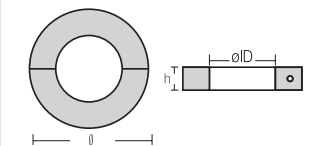
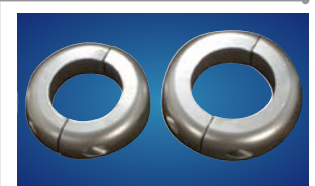

ZINC COLLAR ANODE

Part No.	ØID
2-60550	19mm (¾")
2-60551	22mm (⅞")
2-60552	25mm
2-60553	25.4mm (1")
2-60554	28.6mm (1⅜")
2-60555	30mm
2-60556	31.8mm (1¼")



ZINC HANGING ANODE

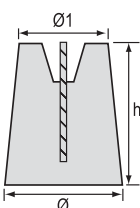

Ø	Ø1	h	kg
80	53	105	2.5

Cable 4.5m
Part No. 2-60630



MAX PROP DOME ANODE

Part No.	Ø	h	ØID
2-60480	65	42	38
2-60481	72	43	42
2-60482	84	60	46
2-60483	100	61	52



DELIVERY

Unable to send via carriers. Please contact your local Aquafax sales depot for method and price of despatch.



SHAFT ANODES

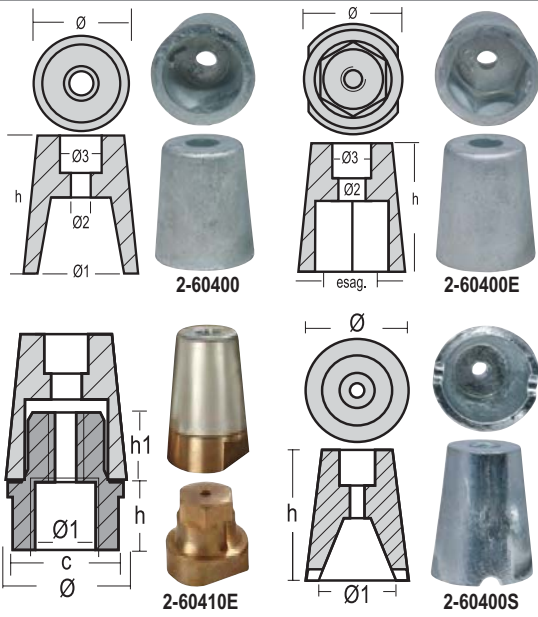

ZINC SHAFT ANODES (BENETEAU)

Tapered - Fit Beneteau, or Hexagonal end

Tapered Part No:	Hexagon Part No:	Ø axis	Ø	Ø2	Ø3	Hex.	h	kg
2-60400	2-60400E	20-25	34	7	11	22	39	0.135
2-60401	2-60401E	30	43	9	17	27	53	0.255
2-60402	2-60402E	35	46	9	18	32	62	0.350
2-60403	2-60403E	40	52	9	18	36	67	0.460
2-60404	2-60404E	45	61	11	24	41	76	0.775
2-60405	2-60405E	50	73	11	24	46	84	1.000
2-60406	2-60406E	50	75	11	22	50	87	1.000
2-60407	2-60407E	60	82	11	23	55	98	1.6000

Zinc Hexagonal end with Brass

Part No:	Ø axis	Ø	Ø1	h	h1	C	kg
2-60410E	22-25	37	16 x 1.5	18	18	22	0.310

Zinc Tapered Sole Anode

Part No:	Ø	Ø1	h	kg
2-60400S	52	41	70	0.600

SUZUKI ANODES

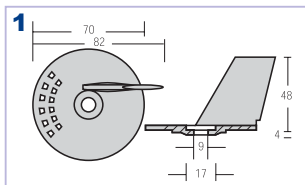

ENGINE FIN
2-61200 Suzuki 20-25-30HP
0.150kg

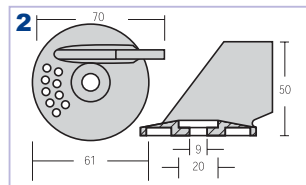

ENGINE FIN
2-61201 Suzuki 55-65HP
0.170kg

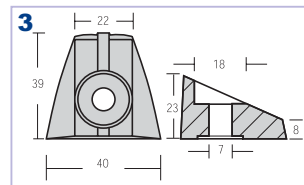

ENGINE CONIC
2-61202 Suzuki F.B. 0.095kg

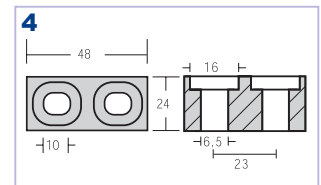

ENGINE CUBE
2-61203 Suzuki F.B. 0.145kg

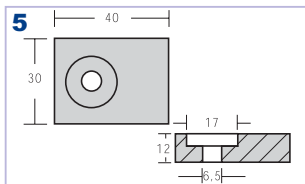

ENGINE PLATE
2-61204 Suzuki 65-115 HP
0.080kg

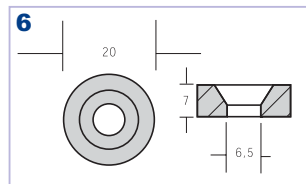

ENGINE RING
2-61205 Suzuki F.B. 20Ø
0.010kg

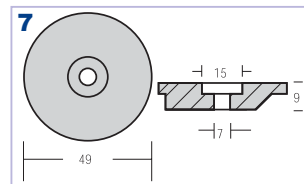

ENGINE PLATE
2-61206 Suzuki 9.9 - 15HP
0.055kg

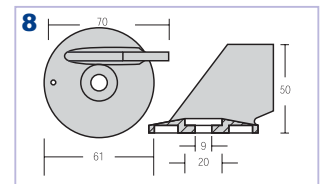

ENGINE FIN
2-61207 Suzuki 75 - 85 HP
0.170kg

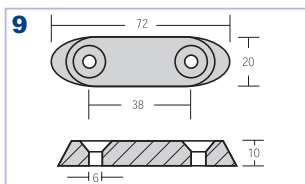

ENGINE PLATE
2-61208 Suzuki 2-4-6-8 HP 0.080kg

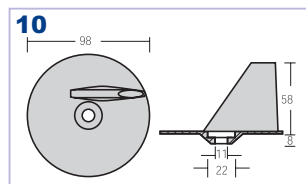

ENGINE FIN
2-61209 Suzuki 115 HP 0.310kg

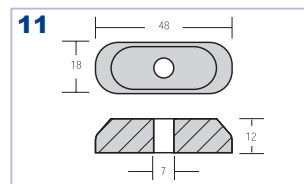

ENGINE PLATE
2-61210 Suzuki 2 HP 0.050kg

FOR PENCIL ANODES
SEE PAGE 34



VOLVO PENTA ANODES



NEW

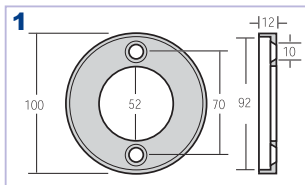

ENGINE COLLAR
2-60700 100 0.210kg

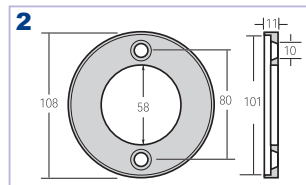

ENGINE COLLAR
2-60701 200 0.260kg

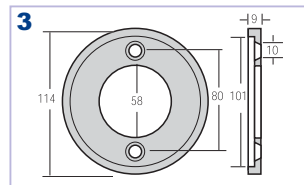

ENGINE COLLAR
2-60702 250/270/275 0.275kg

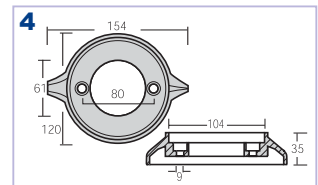

ENGINE COLLAR
2-60703 Volvo 280 0.760kg

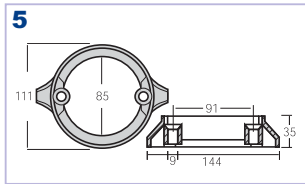

ENGINE COLLAR
2-60704 Volvo 290 Duo Prop 0.550kg

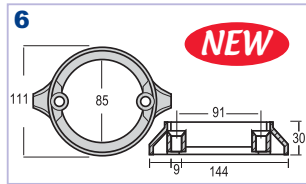

ENGINE COLLAR
2-60704R Volvo 280/290 Duo Prop (reduced depth)* 0.500kg

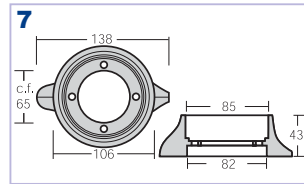

ENGINE COLLAR
2-60705 Volvo 110 S.Drive 0.875kg

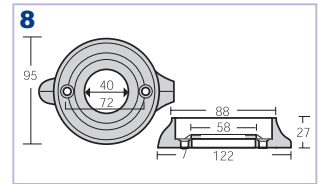

ENGINE COLLAR
2-60706 Volvo 120 S.Drive 0.520kg

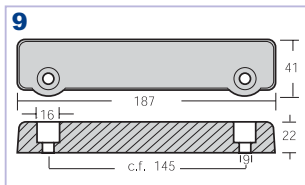

ENGINE BAR
2-60707 Volvo 250/270/280 0.950kg

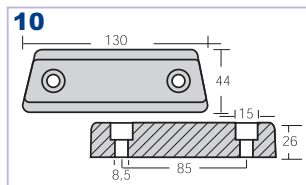

ENGINE BAR
2-60708 Volvo 290 Duo-Prop 0.790kg

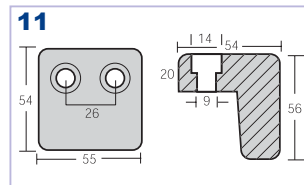

ENGINE SQUARE
2-60709 Volvo Trim 270 0.675kg

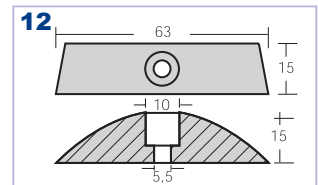

ENGINE PLATE (pair)
2-60710 Volvo 110 - 120 0.110kg

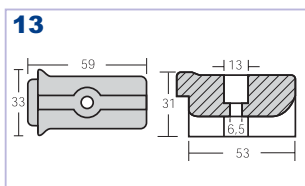

ENGINE PLATE
2-60711 Volvo S. Drive 0.160kg

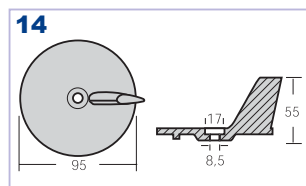

ENGINE FIN
2-60712 Volvo F.B. 0.290kg

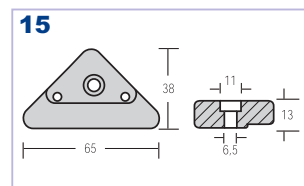

ENGINE PLATE
2-60717 Volvo Duo 0.110kg

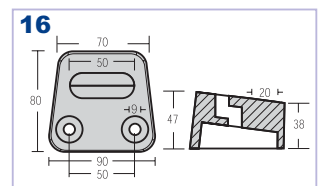

ENGINE PLATE
2-60718 Volvo S. Drive 1.090kg

*compatible with both the old type hub propellers and new type deep hub propellers



VOLVO PENTA ANODES

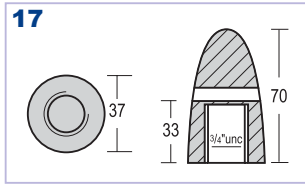

17
SHAFT NUT
2-60719 Ø Axis 25/30 0.290kg

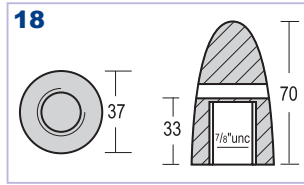

18
SHAFT NUT
2-60720 Ø Axis 35 0.275kg

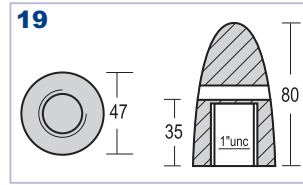

19
SHAFT NUT
2-60721 Ø Axis 40 0.500kg

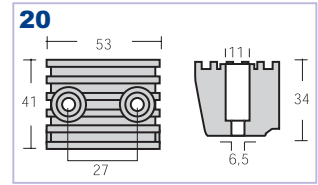

20
ENGINE PLATE
2-60722 DPX 0.370kg

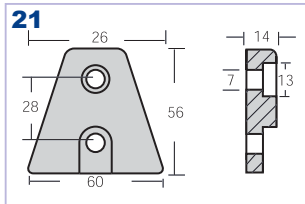

21
ENGINE PLATE
2-60723 DPX 0.210kg

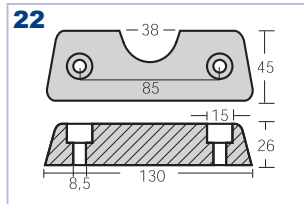

22
ENGINE PLATE
2-60724 DPX 0.695kg

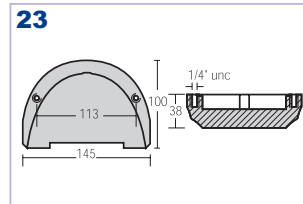

23
ENGINE PLATE
2-60726 1.400kg

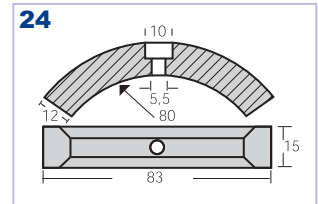

24
PROPELLER COLLAR
2-60728 0.285kg

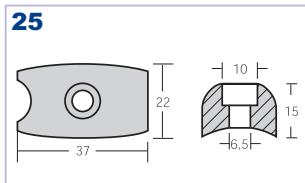

25
BOW THRUSTER PLATE
2-60729 0.045kg

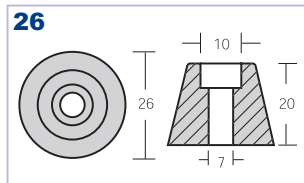

26
BOW THRUSTER CONE
2-60730 0.045kg

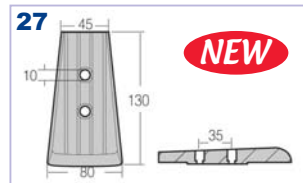

27
CAVITATION PLATE
2-60733 0.860kg

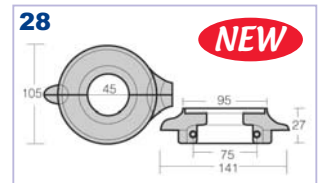

28
SAIL DRIVE
2-60734 1.455kg

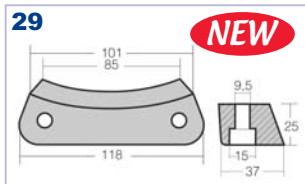

29
GIMBAL PLATE
2-60735 0.515kg



HONDA ANODES

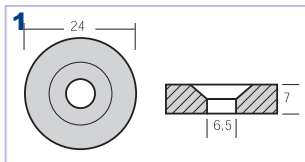

1
ENGINE RING
2-61400 Honda 8 HP 0.015kg

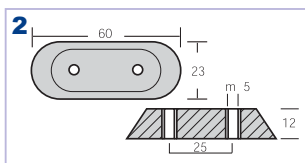

2
ENGINE PLATE
2-61401 Honda F.B. 0.075kg

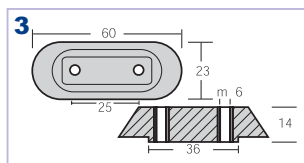

3
ENGINE PLATE
2-61402 Honda 0.085kg

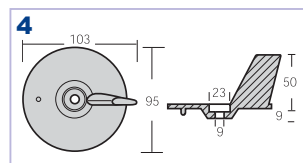

4
ENGINE FIN
2-61403 Honda 0.275kg

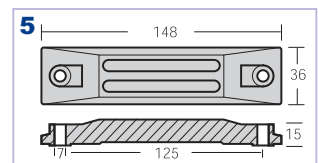

5
ENGINE PLATE
2-61404 Honda 0.380kg

FOR PENCIL ANODES
SEE PAGE 34

MERCURY - MERCURUISER ANODES

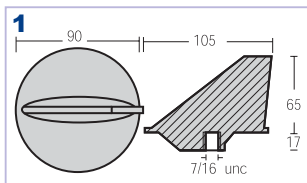

ENGINE FIN
2-60800 Mercury 50 HP
7/16" unc 0.490kg

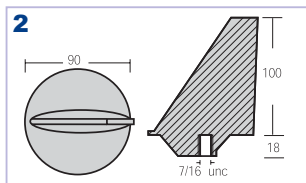

ENGINE FIN
2-60801 Mercruiser 80 -140 HP
7/16" unc 0.620kg

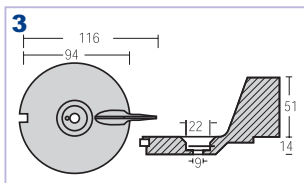

ENGINE FIN
2-60802 Mercury 25 HP
0.275kg

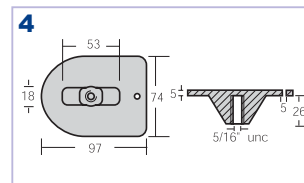

ENGINE PLATE
2-60803 Mercury 20 HP
5/16" unc 0.310kg

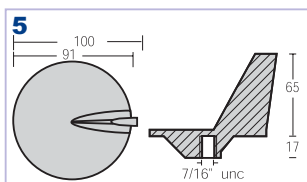

ENGINE FIN
2-60804 Mercury 50-140 HP
7/16" unc 0.395kg

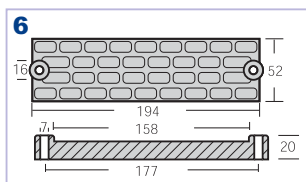

ENGINE FIN
2-60805 Mercury 25 HP/50/60/75
Mercruiser E.B. 90/100 0.665kg

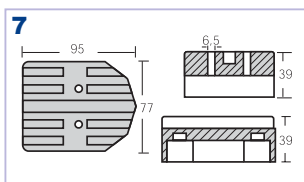

ENGINE PLATE
2-60806 Mercury F.B. -
Mercruiser E.B. 0.895kg

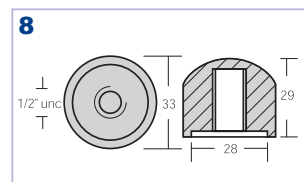

ENGINE NUT
2-60807 Mercruiser E.B.
1/2" unc 0.120kg

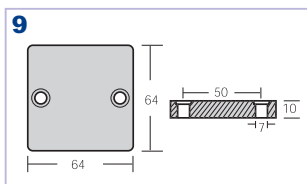

ENGINE PLATE
2-60808 Dim: 64x64x10mm
0.265kg

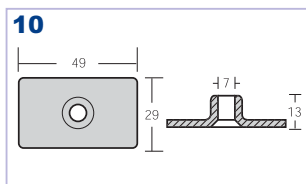

ENGINE PLATE
2-60809 Mercury 4.5 - 9 HP
since 1987 0.035kg

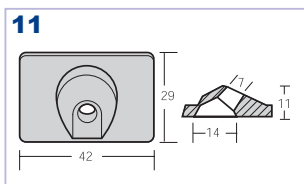

ENGINE PLATES
2-60810 Mercury 6 - 9.9 HP
0.035kg

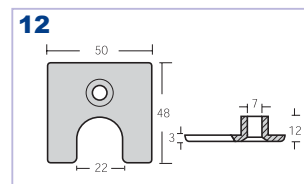

ENGINE PLATES
2-60811 Mercury 4.5 - 7 HP
0.050kg

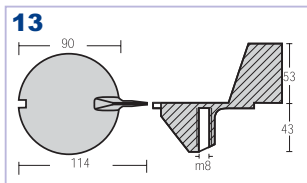

FIN ANODE
2-60812 America 25 HP M8
0.350kg

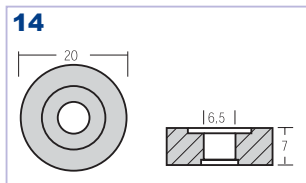

ENGINE RING
2-60813 Mercury- Nissan-
Tohatsu 4.5 HP 0.010kg

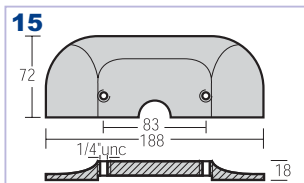

ENGINE PLATE
2-60814 Alpha One 0.900kg

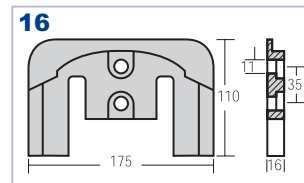

ENGINE PLATE
2-60815 Bravo One 1.015kg



MERCURY - MERCUISER ANODES

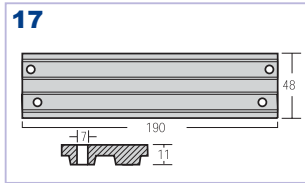

17
ENGINE PLATE
2-60816 Mercury 40/60 HP
0.580kg

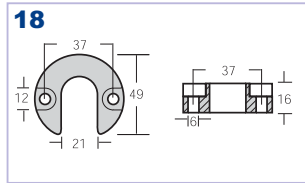

18
TRIM COLLAR
2-60817 Mercruiser Alpha
0.120kg

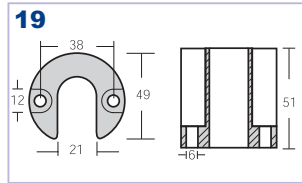

19
TRIM COLLAR
2-60818 Mercruiser Bravo
0.325kg

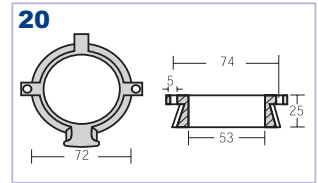

20
ENGINE COLLAR
2-60819 Mercruiser Alpha One
0.240kg

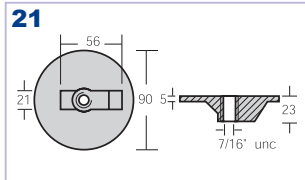

21
ENGINE PLATE
2-60820 Mercury Alpha 0.320kg

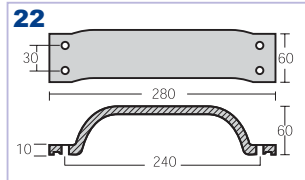

22
ENGINE PLATE
2-60821 150/200 HP 1.190kg

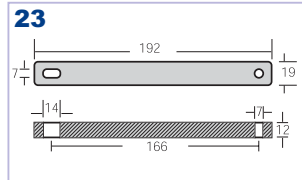

23
ENGINE PLATE
2-60822 30/40 HP 0.300kg

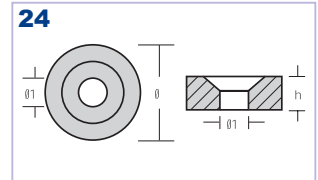

24
ENGINE RING
2-60823 20Ø 7Ø1 7h 0.010kg

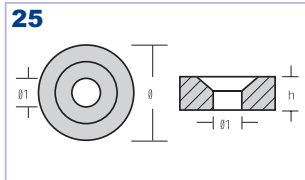

25
ENGINE RING
2-60824 24Ø 6.5Ø1 6.5h
0.020kg

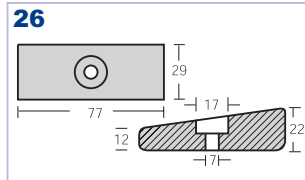

26
ENGINE PLATE
2-60825 75 HP - XR6 0.240kg

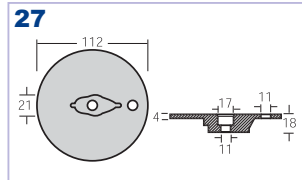

27
ENGINE PLATE
2-60826 112Ø 0.310kg

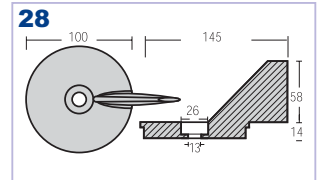

28
ENGINE FIN
2-60827 Formula 60 HP
0.510kg

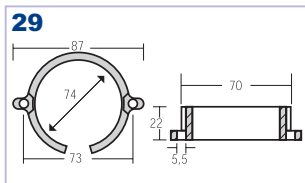

29
ENGINE COLLAR
2-60828 Bravo One 0.170kg

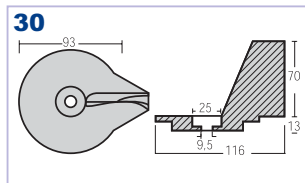

30
ENGINE FIN
2-60829 0.435kg

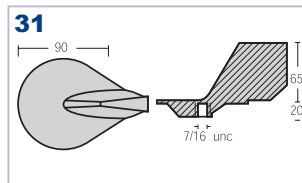

31
ENGINE FIN
2-60830 7/16" unc 0.750kg

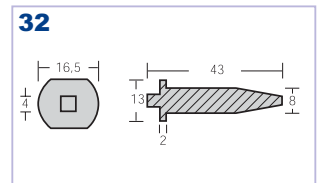

32
ENGINE BAR
2-60831 43l 8Ø 0.015kg

BMW ANODES

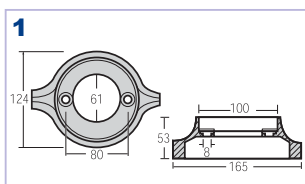
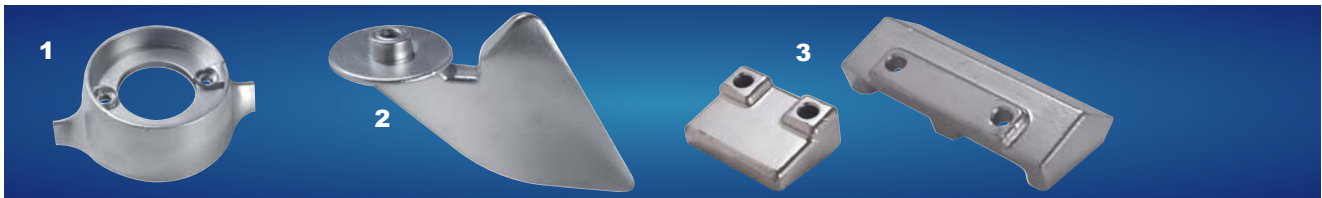

1
ENGINE COLLAR
2-61000 BMW Mark 1 0.875kg

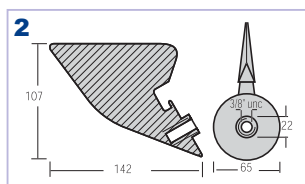

2
LONG ENGINE FIN
2-61001 BMW Mark 2 3/8"unc
0.625kg

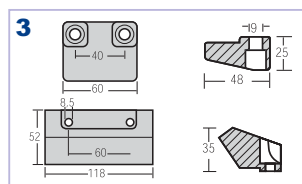

3
ENGINE PLATE
2-61003 BMW 100 Mark 1 0.320kg
2-61004 BMW Mark 2 0.950kg

FOR PENCIL ANODES
SEE PAGE 34

OMC - JOHNSON - EVINRUDE ANODES

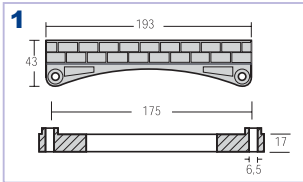

1
TRANSOM
2-60900 OMC P 0.475kg

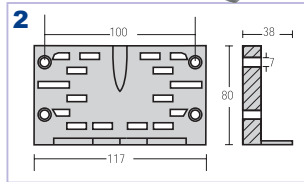

2
ENGINE PLATE
2-60901 OMC M 100-245 HP 0.575kg

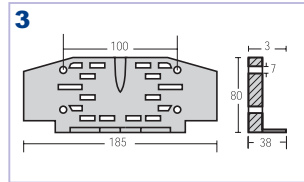

3
ENGINE PLATE
2-60902 OMC G 100-245HP 0.985kg

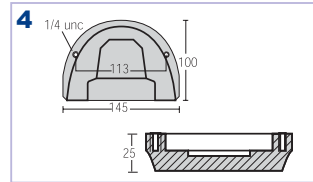

4
FRONT GEAR CASE
2-60903 OMC Cobra 1.030kg

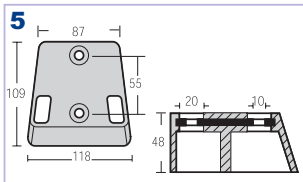

5
ENGINE PLATE
2-60904 OMC Cobra 130-385 HP 1.275kg

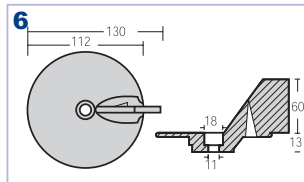

6
ENGINE FIN
2-60905 OMC E.B.- F.B. - 55 HP 0.460kg

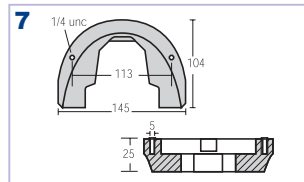

7
GEAR CASE
2-60906 OMC 90HP 0.735kg

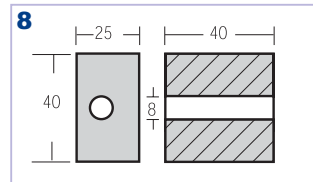

8
ENGINE CUBE
2-60907 OMC 50-60-70-90-140HP Johnson 50-115-120-140 Evinrude 50-140-200 HP 0.255kg

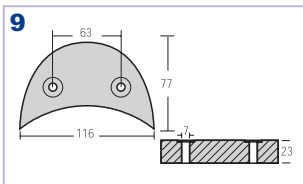

9
ENGINE PLATE
2-60908 OMC 90-140 HP Johnson 90-140 HP Evinrude 90-140 HP 0.820kg

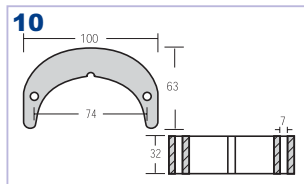

10
ENGINE PLATE
2-60909 OMC 50-75 HP Johnson 50-75 HP Evinrude 50-75 HP 0.700kg

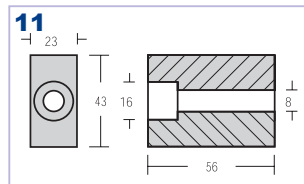

11
ENGINE CUBE
2-60910 Johnson/Evinrude 60-280HP(V4-V6) 0.330kg

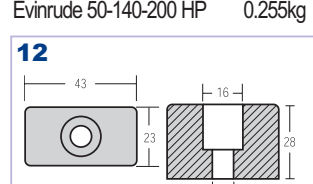

12
ENGINE CUBE
2-60911 OMC Cobra 0.155kg

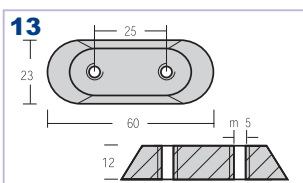

13
ENGINE PLATE
2-60912 Johnson 2-150 HP 0.075kg

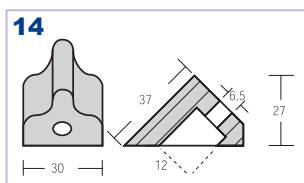

14
ENGINE PLATE
2-60913 Johnson 4-7.5 HP Evinrude 4-7.5 HP 0.075kg

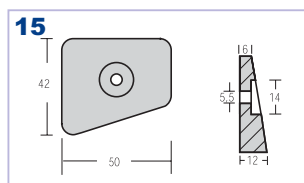

15
ENGINE PLATE
2-60914 Johnson 521 20-25HP 1991 Evinrude 20-25 HP 1991 0.190kg

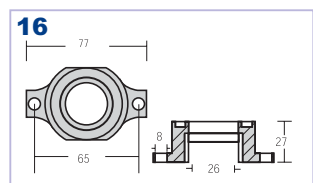

16
ENGINE COLLAR
2-60915 Johnson 737 0.155kg

OMC - JOHNSON - EVINRUDE ANODES

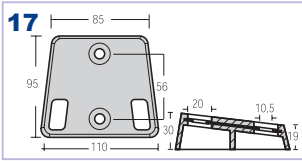

ENGINE PLATE
2-60916 OMC Cobra bassa
0.800kg

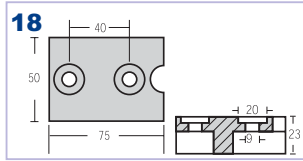

ENGINE PLATE
2-60917 Johnson - Evinrude
Diabolo 70-120 HP 0.300kg

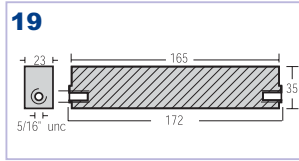

BAR
2-60918 Johnson 60/175 HP
Evinrude 60/175 HP 0.885kg

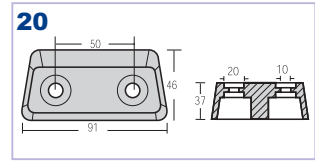

ENGINE PLATE
2-60919 OMC Cobra 0.605kg

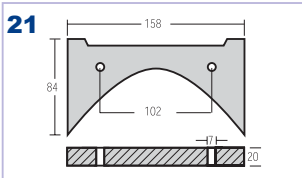

ENGINE PLATE
2-60920 OMC Cobra 5700 0.980kg

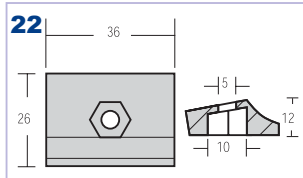

ENGINE PLATE
2-60921 Johnson 8-9, 9-15 HP 0.055kg

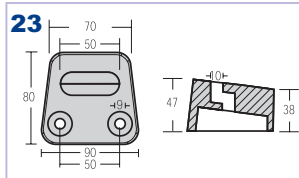

ENGINE PLATE
2-60922 King Cobra 1.090kg

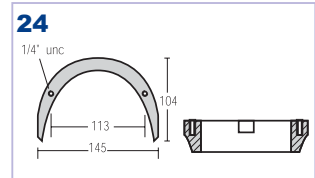

ENGINE PLATE
2-60923 225 HP 0.540kg

TOHATSU ANODES

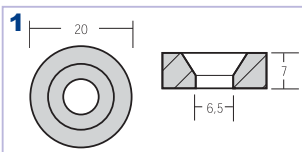

ENGINE RING
2-61250 2.5 - 3.5 - 5 - 6 - 8 HP
20 Ø 0.010kg

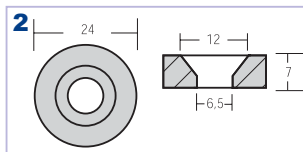

ENGINE RING
2-61251 15/18, 5 maxi, 25-40
corsa 24 Ø 0.020kg

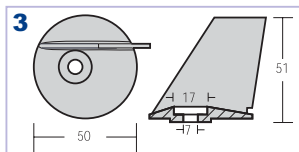

ENGINE FIN
2-61252 maxi corsa 25-40 HP
0.120kg

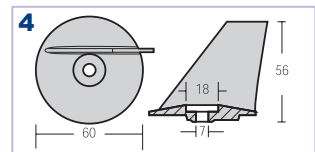

ENGINE FIN
2-61253 mega 25-50 HP
0.150kg

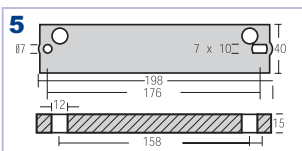

ENGINE PLATE
2-61254 60-70-90 HP
120-140 HP 0.475kg

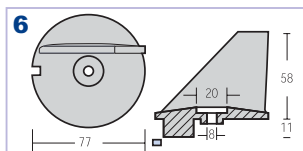

ENGINE FIN
2-61255 60-70-90 HP
120-140 HP 0.345kg

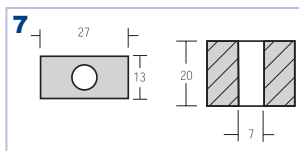

ENGINE CUBE
2-61256 Mega 0.040kg

YANMAR ANODES

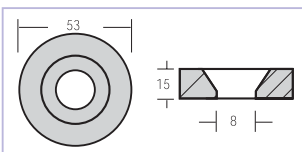

ENGINE RING
2-61302 Yanmar 70-85 HP 0.210kg

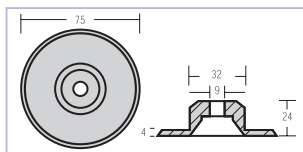

ENGINE PLATE
2-61304 Yanmar 0.190kg

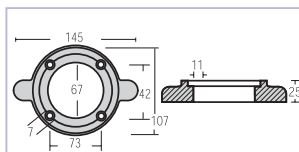

ENGINE COLLAR
2-61305 Yanmar 0.830kg

BUKH ANODE

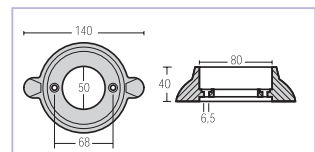

ENGINE COLLAR
2-62051 Bukh Sail Drive 0.885kg

FOR PENCIL ANODES
SEE PAGE 34



MARINER - YAMAHA ANODES

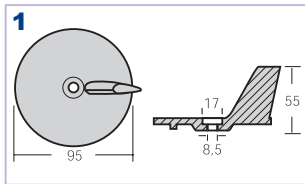
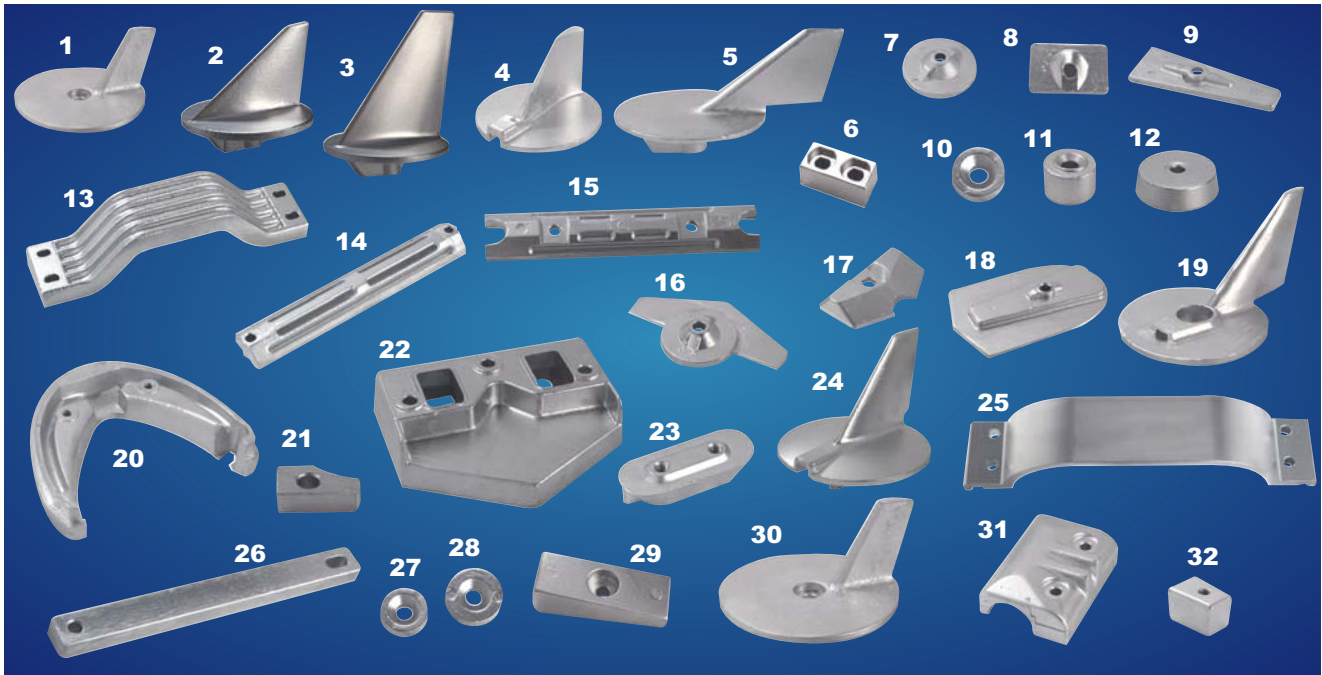

ENGINE FIN
2-61100 Mariner 10-50 HP
Yamaha 20-25-30 HP 0.290kg

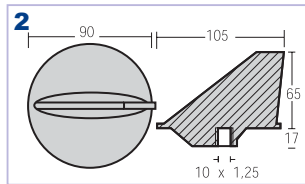

ENGINE FIN
2-61101 Mariner 40-60 HP
Yamaha 55 HP 0.490kg

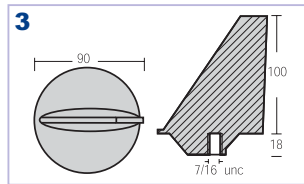

ENGINE FIN
2-61102 Mariner 80 -140 HP
7/16" unc 0.620kg

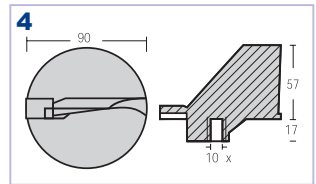

ENGINE FIN
2-61103 Yamaha 115-225 HP
(V4-V6) 10x1.25 0.400kg

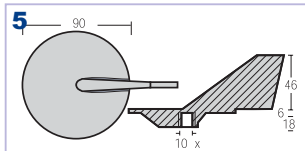

ENGINE FIN
2-61104 Yamaha 60-90 HP
10x1.25 0.420kg

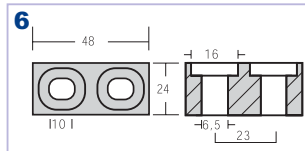

ENGINE CUBE
2-61105 Yamaha 115 - 225 HP
0.145kg

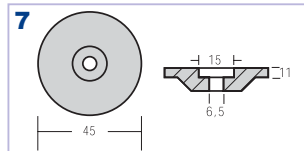

ENGINE PLATE
2-61106 Yamaha 9.9 HP
0.045kg

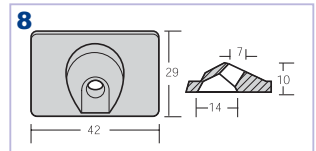

ENGINE PLATE
2-61107 Mariner 6 - 9.9 HP
0.035kg

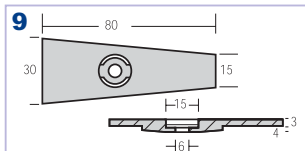

ENGINE PLATE
2-61108 Yamaha 6-8 HP
0.037kg

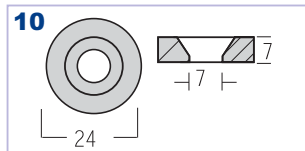

ENGINE RING
2-61109 Mariner/Yamaha 2-25 HP
0.020kg

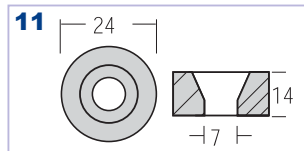

ENGINE RING
2-61110 Yamaha 60-85-115HP
0.040kg

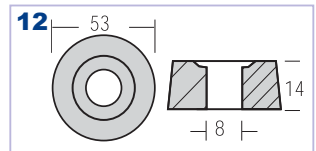

ENGINE RING
2-61111 Marine 40HP
Yamaha 70-85HP 0.210kg

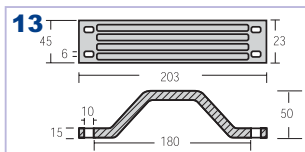

ENGINE BAR
2-61112 Yamaha 115-225 HP
0.950kg

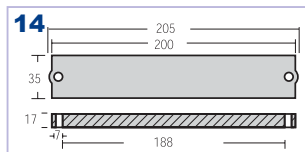

ENGINE BAR
2-61113 Yamaha 60-90 HP
0.520kg

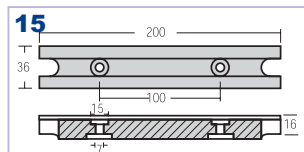

ENGINE BAR
2-61115 Yamaha TOP700
0.460kg

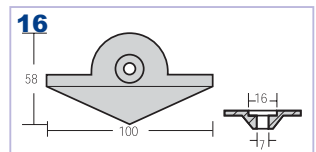

ENGINE PLATE
2-61116 Yamaha 9.9 -15 HP
0.140kg



MARINER - YAMAHA ANODES

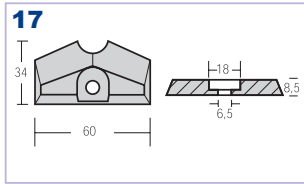

17
ENGINE PLATE
2-61117 Yamaha Malta 3.5 HP
0.065kg

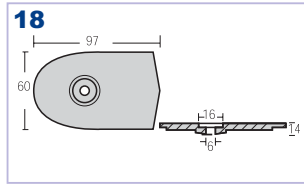

18
ENGINE PLATE
2-61118 Yamaha 6C - 6D - 8C
0.190kg

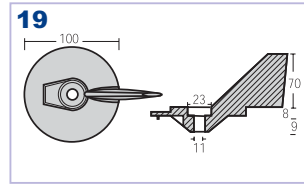

19
ENGINE FIN
2-61119 Yamaha 130-205-230-260
0.580kg

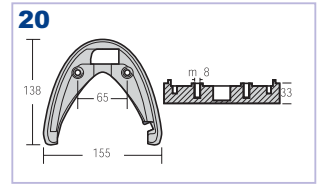

20
ENGINE PLATE
2-61120 Yamaha 130-205-230-260
1.050kg

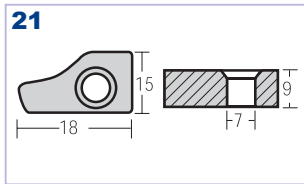

21
ENGINE PLATE
2-61121 Mariner H25 - H8
Yamaha W30-W8
0.020kg

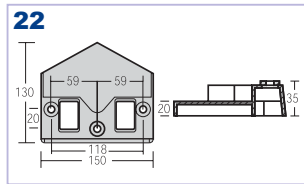

22
ENGINE PLATE
2-61122 Yamaha V8
1.440kg

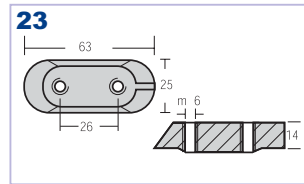

23
ENGINE PLATE
2-61123 Yamaha FB
0.100kg

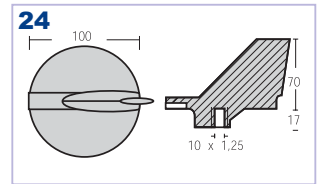

24
ENGINE FIN
2-61124 Yamaha V6
0.680kg

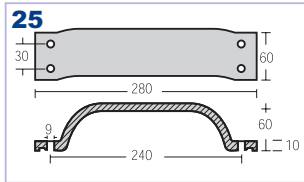

25
ENGINE PLATE
2-61125 150 / 200 HP
1.190kg

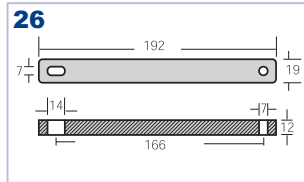

26
ENGINE PLATE
2-61126 30 / 40 HP
0.300kg

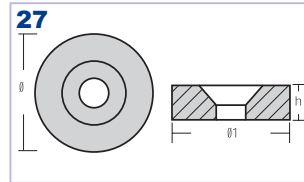

27
ENGINE RING
2-61127 20Ø 7h 6.5Ø1
0.015kg

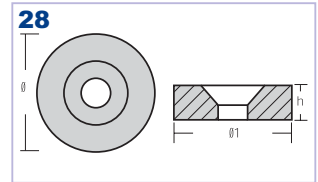

28
ENGINE RING
2-61128 24Ø 6.5h 6.5Ø1
0.020kg

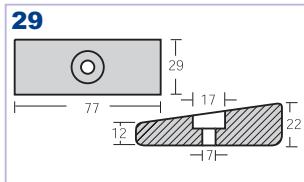

29
ENGINE PLATE
2-61129 75HP - XR6
0.240kg

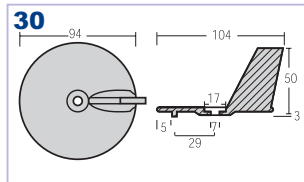

30
ENGINE PLATE
2-61130 Yamaha 25-30 HP
0.275kg

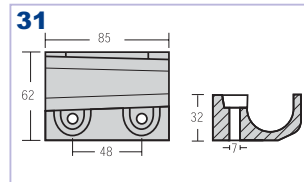

31
ENGINE PLATE
2-61131 c.f.48
0.610kg

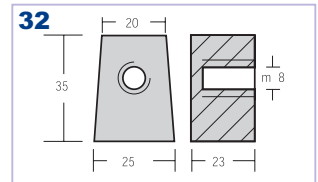

32
CUBE WITH HOLE
2-61132
0.115kg

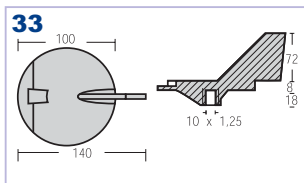

33
ENGINE FIN
2-61133 Yamaha 220 HP DX
0.625kg

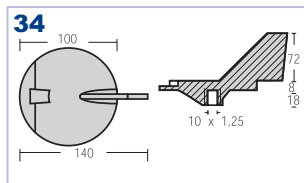

34
ENGINE FIN
2-61134 Yamaha 220 HP SX
0.625kg

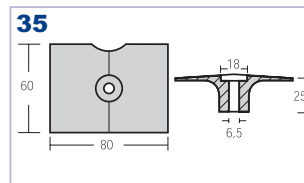

35
ENGINE PLATE
2-61135 4T
0.265kg

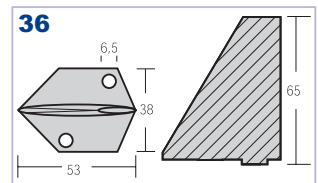

36
ENGINE PLATE
2-61136 9.9 HP 4T
0.085kg

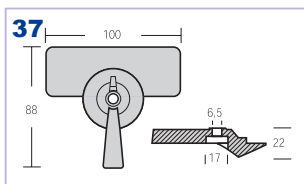

37
ENGINE PLATE
2-61137 9.9 HP
0.225kg



FOR PENCIL ANODES
SEE PAGE 34

Tecnoseal Zinc Pencil Anodes & CEF Impellers



Aquafax

ZINC PENCIL ANODES

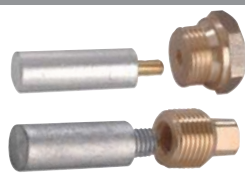

Engine Manufacturer	Series	Part No.	Anode Dia. (A)mm	Anode Length (B)mm	Thread Dia. (C)	Thread Length (D)mm	Threaded Plug P/ No.
General Motors		2-62000	16	54	7/16" UNC	12	2-62000TP
		2-62001	19	85	5/8" UNC	15	2-62001TP
		2-62002	19	54	5/8" UNC	15	2-62002TP TO
		2-62003	12	40	3/8" UNC	10	2-62003TP
Aifo	821	2-62010	14	26	12	8	2-62010TP TO
	828	2-62011	20	20	14	11	2-62011TP TO
	8361	2-62012	13	26	10.1	8	2-62012TP TO
	44/700	2-62013	10	18	7	8	2-62013TP TO
Caterpillar*	3208	2-62020	14	26	12mm	7	
	2283	2-62021	10	55	1/4" UNC	11	2-62021TP
	2016	2-62022	22	20	5/8" UNF	11	
	2289	2-62023	16	76	3/8" UNC	13	2-62023TP
	2288	2-62024	16	63	3/8" UNC	13	2-62024TP TO
		2-62025	14	33	5/16" UNC	12	
	2284	2-62026	28	55	3/4" UNC	20	2-62026TP
	2280	2-62027	12	40	3/8" UNC	10	2-62027TP
3126	2-62029	12.5	38	7/16" UNF	10	2-62029TP	
Onan		2-62030	10	30	8 MA	6	
		2-62031	13	26	9.5mm	5	
		2-62032	10	31	M8	9	
		2-62033	12	40	3/8" UNC	10	
Cummins*		2-62040	18	65	16 x 1.5	15	
		2-62041	16	45	3/8" UNC	13	
		2-62042	10	20	6 MA	8	
		2-62043	16	50	15.5mm	10	2-62043TP
Bukh		2-62050	12	35	M5	12	2-62050TP
		2-62052	12	40	3/8" UNC	10	
		2-62053	10	18	8.5mm	8	2-62053TP TO
V.M.		2-62060	14	40	M8	10	2-62060TP TO
		2-62061	14	20	M8	10	2-62061TP TO
Ford		2-62070	10	18	8.5mm	8	2-62070TP TO
		2-62071	14	26	12mm	7	2-62071TP TO
Renault		2-62090	15	22	12mm	10	2-62090TP
Nanni Mercedes		2-62100	10	17	8mm	9	2-62100TP TO
		2-62101	14	26	10mm	8	
		2-62102	26	25	22mm	10	
Scania*		2-62200	17	45	12x1	10	
Boudouin		2-62300	20	45	8x1.25	11	2-62300TP TO
Lombardini		2-62350	14	20	12mm	7	2-62350TP
		2-62351	10	18	8.5mm	8	2-62351TP
Volvo Penta 200/250/270		2-60713	15.5	40	7/16" UNC	10	2-60713TP TO
		2-60714	16	30	7/16" UNC	10	2-60714 (TPM/TPF)
		2-60715	16.5	13	5/16" UNC	10	
		2-60716	25	44	3/8" UNC	10	2-60716TP
BMW		2-61005	13	50	3/8" UNC	13	
Yamaha		2-61114	20	39	M8	11	
Yanmar*	8-10 HP	2-61300	30	40	M8		
	8-12 HP	2-61301	20	30	M8		
		2-61303	20	20	M8		
	8-12 HP	2-61306	20	55	M8		
Castoldi		2-62402	22	26	M10	7	
Kelvin		2-63000	20	19	12ANF	5	
		2-63001	16	19	12ANF	7	

TO = Part No.s in red are to order only

* Other Zinc Pencil Anodes for these engine manufacturers may be available to special order. Contact our sales office as minimum purchase quantities may apply.

CEF IMPELLERS



HONDA OUTBOARD ENGINE IMPELLERS

Application	Aquafax Part No.	OE No.
5 HP	2-50327	19210-881-003
		19210-881-A01
5 HP BF50	2-50327	19210-881-003
		19210-881-A01
5 HP BF5A	2-50327	19210-881-003
		19210-881-A01
7.5 HP BF75	2-50327	19210-881-003
		19210-881-A01
8/10 HP	2-50347	19210-ZV9-003
8/10 HP	2-50348	19210-ZV9-A31
8 HP	2-50327	19210-881-003
		19210-881-A01
8 HP	2-50343	19210-ZV4-651
9.9 HP BF	2-50328	19210-ZV4-013
9.9 HP	2-50343	19210-ZV4-651
15 HP BF	2-50328	19210-ZV4-013
15 HP	2-50343	19210-ZV4-651
20 HP	2-50339	19210-ZV7-003
25 HP	2-50339	19210-ZV7-003
30 HP	2-50339	19210-ZV7-003
35 HP	2-50338	19210-ZV5-003
40 HP	2-50338	19210-ZV5-003
45 HP	2-50338	19210-ZV5-003
50 HP	2-50338	19210-ZV5-003
75 HP	2-50301	19210-ZW1-003
75 HP	2-50337	19210-ZW1-B02
90 HP	2-50301	19210-ZW1-003
90 HP	2-50337	19210-ZW1-B02
10 HP BF100	2-50327	19210-881-003
		19210-881-A01
115 HP	2-50337	19210-ZW1-B02
130 HP	2-50337	19210-ZW1-B02
175/225 HP	2-50391	19210-ZY3-003

TOHATSU OUTBOARD ENGINE IMPELLERS

Application	Aquafax Part No.	OE No.
4-5-6 HP 2 & 4 stroke	2-50377	369-65021-1
6-8-9,8 HP 2 Stroke	2-50344	3B2-65021-1
9,9-15-18 HP 2 Stroke	2-50383	334-65021-0
15-18HP 4 Stroke	2-50383	334-65021-0
25-30 HP 2 Stroke	2-50382	345-65021-0
40-50 HP 2 Stroke	2-50379	3C8-65021-2
70-90 HP 2 Stroke	2-50388	3C7-65021-1
		3B7-65021-2
120-140 HP 2 Stroke	2-50388	3C7-65021-1
		3B7-65021-2

SELVA OUTBOARD ENGINE IMPELLERS

Application	Aquafax Part No.	OE No.
6 HP 120/130 ONLY 1971-1980	2-50387	8095020
4-6 HP 1981-1986	2-50387	8095020
6-15 HP Twin Cyl 1972 on	2-50387	8095020
20-35 HP 1981 on	2-50386	8095050
40-100hp 700 series 1972 on	2-50304	8095060



CEF IMPELLERS

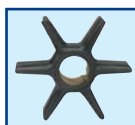

2-50301



2-50312



2-50378



2-50321

MARINER OUTBOARD ENGINE IMPELLERS

Application	Aquafax Part No.	OE No.
4A HP (M-6EO-001011>)	2-50325	47-96305M
4A HP (ML-6EO-300101>)	2-50325	47-96305M
5C HP (M-6E3-102151>)	2-50325	47-96305M
5C HP (ML-6E3-400101>)	2-50325	47-96305M
8B HP (M-677-000101>)	2-50321	47-95611M
8B HP (ML-677-300101>)	2-50321	47-95611M
40 HP (4 Cyl) 4 Stroke	2-50378	47-19453T
40 HP EFI 4 Stroke	2-50378	47-19453T
40 HP JET	2-50378	47-19453T
45 HP JET	2-50378	47-19453T
50 HP (4 Cyl) 4 Stroke	2-50378	47-19453T
50 HP (5531630>)	2-50312	47-20268 47-65959 47-89983
50 HP EFI 4 Stroke	2-50378	47-19453T
55 HP (3 Cyl)	2-50378	47-19453T
60 HP (3 Cyl)	2-50378	47-19453T
60 HP (4 Cyl) 4 Stroke	2-50378	47-19453T
60 HP EFI 4 Stroke	2-50378	47-19453T
70 HP (5361993-5702219)	2-50312	47-20268 47-65959 47-89983
70 HP (A996142>)	2-50301	47-43026-T2
70 HP (B240451>)	2-50301	47-43026-T2
75 HP (4 Cyl) (6432901>)	2-50313 (1)	47-65960 47-89984
75 HP (A996142>)	2-50301	47-43026-T2
75 HP (B24051>)	2-50301	47-43026-T2
75 HP (C222000-D382221)	2-50301	47-43026-T2

Application	Aquafax Part No.	OE No.
80 HP (4 Cyl) (4842729-6432900)	2-50313 (1)	47-65960 47-89984
85 HP (4 Cyl) (4731898-4842728)	2-50313 (1)	47-65960 47-89984
90 HP (6 Cyl) (5309951-)	2-50313 (1)	47-65960 47-89984
90 HP (A996142>)	2-50301	47-43026-T2
90 HP (B240451>)	2-50301	47-43026-T2
90 HP (C222000>)	2-50301	47-43026-T2
100 HP (B209468>)	2-50301	47-43026-T2
115 HP (6 Cyl) (4865178-)	2-50313 (1)	47-65960 47-89984
115 HP (C100000-D283221)	2-50301	47-43026-T2
140 HP (6 Cyl) (5088444-)	2-50313 (1)	47-65960 47-89984
15A HP (<M-651-000285>)	2-50321	47-95611M
15A HP (<ML-651-300101>)	2-50321	47-95611M
MAG II (B082000-)	2-50313 (1)	47-65960 47-89984
MAG II (B242885-)	2-50313 (1)	47-65960 47-89984
V-135 HP (0A904646-)	2-50313 (1)	47-65960 47-89984
V-150 HP (5600162-0A904645)	2-50313 (1)	47-65960 47-89984
V-150 HP (A904646)	2-50313 (1)	47-65960 47-89984
V-175 HP (5190663-6618750)	2-50313 (1)	47-65960 47-89984
V-175 HP (6618751-)	2-50313 (1)	47-65960 47-89984
V-200 HP (5624878-6625220)	2-50313 (1)	47-65960 47-89984
V-200 HP (6625221-)	2-50313 (1)	47-65960 47-89984
V-220 HP (B117316-)	2-50313 (1)	47-65960 47-89984



2-50322



2-50325



2-50352



2-50368

YAMAHA OUTBOARD ENGINE IMPELLERS

Application	Aquafax Part No.	OE No.
2 HP (1985-1989)	2-50324	646-44352-01-00
3 HP MALTA (1990 - >)	2-50322	6L5-44352-00-00
4 HP (1985-89)	2-50325	6E0-44352-00-00
4 HP (1999 >>) 4 Stroke	2-50325	6E0-44352-00-00
5 HP (1985)	2-50325	6E0-44352-00-00
6 HP (non domestic)	2-50321	662-44352-01-00
6-8 HP 4 Stroke	2-50368	68T-44352-00-00
8 HP (non domestic)	2-50321	662-44352-01-00
8/9.9 HP (1999 >>) 4 Stroke	2-50320	682-44352-01-00
9.9 HP (1985-1993)	2-50320	682-44352-01-00
15 HP (1985)	2-50320	682-44352-01-00
15 HP (1987-188)	2-50320	682-44352-01-00
15 HP (1999 >>) 4 Stroke	2-50363	63V-44352-01-00
25 HP (1984-1987)	2-50326	689-44352-02-00
25 HP (1990-1993)	2-50326	689-44352-02-00
25 HP (1999 >>) 4 Stroke	2-50385 (1)	6H4-44352-02-00
30 HP (1985-1986)	2-50326	689-44352-02-00
30 HP (1989) V3DE	2-50326	689-44352-02-00
30 HP (1991)	2-50326	689-44352-02-00

Application	Aquafax Part No.	OE No.
40 HP (1984-1989)	2-50385 (1)	6H4-44352-02-00
40 HP (1990-1994)	2-50352	6F5-44352-00-00
40/50 HP (1999 >>) 4 Stroke	2-50316	697-44352-00-00 6H3-44352-00-00
50 HP (1985-1993)	2-50385	6H4-44352-02-00
55 HP (1989-1993)	2-50316	697-44352-00-00 697-44352-00-00
6/8 HP (1991 >) 2 cyl.	2-50302	6G1-4452-00-00
80/100 HP (1999 >) 4 Stroke	2-50364	67F-44352-00-00
85E HP (1989-1990)	2-50323	688-44352-03-00
90 HP (1985-1993)	2-50323	688-44352-03-00
115 HP (1984-1992)	2-50371	6E5-44352-00-00
115 HP (1993-1994)	2-50371	6E5-44352-00-00
130 HP (1988-1992)	2-50371	6E5-44352-00-00
130 HP (1993-1994)	2-50371	6E5-44352-00-00
150 HP (1984-1991)	2-50371	6E5-44352-00-00
150 HP (1992-1994)	2-50371	6E5-44352-00-00
175 HP (1984-1991)	2-50371	6E5-44352-00-00
175 HP (1992-1994)	2-50371	6E5-44352-00-00
20/25 N (1991 >) 2 cyl.	2-50384	6L2-44352-00-00
200 HP (1984-1990)	2-50371	6E5-44352-00-00
200 HP (1991-1994)	2-50371	6E5-44352-00-00
225 HP (1990-1991)	2-50371	6E5-44352-00-00
225 HP (1992-94)	2-50371	6E5-44352-00-00
250 HP (1990-1994)	2-50371	6E5-44352-00-00

(1) comes complete with gasket

CEF IMPELLERS



2-50314



2-50318



2-50377



2-50309

MERCURY OUTBOARD ENGINE IMPELLERS

Application	Aquafax Part No.	OE No.
2.4 EFI HP (all)	2-50313 (1)	47-65960 47-89984
3.5 HP (6202173>)	2-50314	47-89980 47-68 988
3.6 HP (5404657>)	2-50314	47-89980 47-68 988
4 HP (2498136-3296136)	2-50310	47-65957 47-89981
4 HP (5589202-5595531)	2-50314	47-89980 47-68988
4 HP (5595532>)	2-50310	47-65957 47-89981
4.5 HP (4107220-5595531>)	2-50310	47-65957 47-89981
4.5 HP (5595532>)	2-50310	47-65957 47-89981
4/5/6 HP 4 Stroke	2-50377	47-16154
5 HP (all)	2-50310	47-65957 47-89981
5 HP (all)	2-50314	47-89980 47-68988
6 HP (1408611-1916138)	2-50309	47-22748
6 HP (1916139-2529894)	2-50310	47-65957 47-89981
7.5 HP (2529895-3274632)	2-50310	47-65957 47-89981
7.5 HP (5206650>)	2-50310	47-65957 47-89981
8 HP 4 Stroke	2-50315	47-85089-3 47-85089-10
9.8 HP (1470349-1865778)	2-50309	47-22748
9.8 HP (1865779-5206549)	2-50310	47-65957 47-89981
9.8 HP (5206550>)	2-50310	47-65957 47-89981
9.9/15 HP 4 Stroke	2-50318	47-42038
18 HP (5837437-6416712)	2-50315	47-85089-3 47-85089-10
20 HP (2827677-3226957)	2-50311 (1)	47-65958 47-89982
20XD HP (6443973>)	2-50315	47-85089-3 47-85089-10
25/40/50 HP (5232005) 4 Stroke	2-50315	47-85089-3 47-85089-10
25XD HP (6443973>)	2-50315	47-85089-3 47-85089-10
30 HP (1217222-1448139)	2-50312	47-20268 47-65959 47-89983
35 HP (1571114-1812753)	2-50312	47-20268 47-65959 47-89983
35 HP (6445653-B110788)	2-50312	47-20268 47-65959 47-89983
40 HP (1279685-1476509)	2-50312	47-20268 47-65959 47-89983

Application	Aquafax Part No.	OE No.
40 HP (2874704-3336257)	2-50312	47-20268 47-65959 47-89983
40 HP (4362215-4860102)	2-50312	47-20268 47-65959 47-89983
40 HP (4862103-6445652)	2-50312	47-20268 47-65959 47-89983
40 HP (4Cyl) 4 Stroke	2-50378	47-19453T
40 HP EFI 4 Stroke	2-50378	47-19453T
40 HP JET	2-50378	47-19453T
45 HP (1476510-1520983)	2-50312	47-20268 47-65959 47-89983
45 HP (1520984-1531568)	2-50312	47-20268 47-65959 47-89983
45 HP (5531630>)	2-50312	47-20268 47-65959 47-89983
45 HP JET	2-50378	47-19453T
50 HP (1421113-1639472)	2-50312	47-20268 47-65959 47-89983
50 HP (1521914-2305100)	2-50312	47-20268 47-65959 47-89983
50 HP (2305101-2858813)	2-50312	47-20268 47-65959 47-89983
50 HP (4357640-4962055)	2-50312	47-20268 47-65959 47-89983
50 HP (4962056 >)	2-50312	47-20268 47-65959 47-89983
50 HP (4Cyl) 4 Stroke	2-50378	47-19453T
50 HP EFI 4 Stroke	2-50378	47-19453T
55 HP (3Cyl)	2-50378	47-19453T
60 HP (3Cyl)	2-50378	47-19453T
60 HP (4Cyl) 4 Stroke	2-50378	47-19453T
60 HP (6428681 >)	2-50312	47-20268 47-65959 47-89983
65 HP (1542745-2309310)	2-50313 (1)	47-65960 47-89984
65 HP (2309311-2803561)	2-50313 (1)	47-65960 47-89984
65 HP (2803562-3293183)	2-50312	47-20268 47-65959 47-89983
70 HP (1413611-1566239)	2-50313 (1)	47-65960 47-89984
70 HP (4571652-4977156)	2-50312	47-20268 47-65959 47-89983
70 HP (4977157-6428680)	2-50312	47-20268 47-65959 47-89983
70 HP (A996142 >)	2-50301	47-43026-T2
70 HP (B240451 >)	2-50301	47-43026-T2
75 HP (4Cyl.) (6432901 >)	2-50313 (1)	47-65960 47-89984
75 HP (C222000-D283221)	2-50301	47-43026-T2
75-90 HP 4T	2-50301	47-43026-T2

(1) comes complete with gasket



CEF IMPELLERS

Application	Aquafax Part No.	OE No.
80 HP (1335465-1398629)	2-50313 (1)	47-65960 47-89984
80 HP (1398630-1566239)	2-50313 (1)	47-65960 47-89984
80 HP (2559001-3493912)	2-50313 (1)	47-65960 47-89984
80 HP (4831999-6432900)	2-50313 (1)	47-65960 47-89984
80 HP (A996142 >)	2-50301	47-43026-T2
80 HP (B240451 >)	2-50301	47-43026-T2
80 HP EFI 4 Stroke	2-50378	47-19453T
85 EL HP (4590512-4831998)	2-50313 (1)	47-65960 47-89984
85 HP (1460999-1766823)	2-50313 (1)	47-65960 47-89984
85 HP (3493913-4366801)	2-50313 (1)	47-65960 47-89984
85 XS HP (4366802-4831998)	2-50313 (1)	47-65960 47-89984
90 HP (1766824-1869775)	2-50313 (1)	47-65960 47-89984
90 HP (6Cyl.) (4845301-5299505)	2-50313 (1)	47-65960 47-89984
90 HP (A996142 >)	2-50301	47-43026-T2
90 HP (B240451 >)	2-50301	47-43026-T2
90 HP (C222000-D283221)	2-50301	47-43026-T2
95 HP (1869776-2318585)	2-50313 (1)	47-65960 47-89984
100 HP (1464949-1768403)	2-50313 (1)	47-65960 47-89984
100 HP (1768404-2318585)	2-50313 (1)	47-65960 47-89984
100 HP (2318586-2836108)	2-50313 (1)	47-65960 47-89984
100 HP (B209468-D283221)	2-50301	47-43026-T2
110 HP (1870204-2314955)	2-50313 (1)	47-65960 47-89984
115 HP (2836019-3255440)	2-50313 (1)	47-65960 47-89984
115 HP (C100000-D283221)	2-50301	47-43026-T2
125 HP (2314956-2839368)	2-50313 (1)	47-65960 47-89984
125 HP (2839369-3293233)	2-50313 (1)	47-65960 47-89984
135 HP (A904646 -)	2-50313 (1)	47-65960 47-89984
140 HP (3293234-3502805)	2-50313 (1)	47-65960 47-89984
140 HP (4865678-5327662)	2-50313 (1)	47-65960 47-89984
150 HP (3502806-4865677)	2-50313 (1)	47-65960 47-89984
150 HP (4868998-A904645)	2-50313 (1)	47-65960 47-89984
150 HP (A904646 -)	2-50313 (1)	47-65960 47-89984
175 HP (4301235-6618750)	2-50313 (1)	47-65960 47-89984
175 HP (6618751 -)	2-50313 (1)	47-65960 47-89984
200 HP (4839034-6625220)	2-50313 (1)	47-65960 47-89984
200 HP (6625221 -)	2-50313 (1)	47-65960 47-89984
220 HP (B117316 -)	2-50313 (1)	47-65960 47-89984

Application	Aquafax Part No.	OE No.
225 HP (5628028 -)	2-50313 (1)	47-65960 47-89984
MK35A (all)	2-50312	47-20268 47-65959 47-89983
MK5/MK6 (all)	2-50309	47-22748
mod.VP HP (all)	2-50313 (1)	47-65960 47-89984
WH6/WH6A (all)	2-50309	47-22748
XR/4 HP (B242885 -)	2-50313 (1)	47-65960 47-89984



SUZUKI OUTBOARD ENGINE IMPELLERS

Application	Aquafax Part No.	OE No.
9.9/15 CV	2-50327	17461-93902
9.9/8CV	2-50319	17461-93901
200/225/280 HP 4 Stroke	2-50393	17461-93J00
90/115 HP 4 Stroke	2-50367	17461-94511
DF60/DF70 (1998->) 4 Stroke	2-50365	17461-87E00 17461-87E10
DT8 (2001->)	2-50036	17461-98503
DT20 (1986-88)	2-50362 (1)	17461-96301
DT20VE-25QD-25VE- 30VE-30QD-40VE	2-50362 (1)	17461-96301
DT25 (1984-88)	2-50362 (1)	17461-96301
DT25C (1989-95)	2-50362 (1)	17461-96301
DT30 (1984-87)	2-50362 (1)	17461-96301
DT30C (1988-95)	2-50362 (1)	17461-96301
DT35 (1987-89)	2-50362 (1)	17461-96301
DT40C (1984-95)	2-50362 (1)	17461-96301
DT40VZ-DT40QD-DT50C-	2-50361	17461-94700
DT50D-DT50VZ		17461-95201
DT50QD-DT65VZ-	2-50361	17461-94700
DT60QD-DT65QD		17461-95201
DT50VE-DT60VE-DT75VE-	2-50360	17461-95300
DT85VE-DT85Q-D-DT85VZ		17461-95501
DT55 (1985-95)	2-50312	
DT65 (1985-95)	2-50312	
DT75 (1985-95)	2-50360	17461-95300 17461-95501
DT85 (1985-95)	2-50360	17461-95300 17461-95501
DT90/DT100 (1990->) 2 Stroke	2-50365	17461-87E00 17461-87E10 17461-87E11

FORCE OUTBOARD ENGINE IMPELLERS

Application	Aquafax Part No.	OE No.
9.9 - 15 HP	2-50334	47-F436065-Z
25 - 35 HP	2-50335	47-F462065
75 - 140 HP	2-50390	47-F523065-1
90/120 HP - F5 150 HP - 5 Cyl (88>)	2-50313 (1)	47-F694065 47-803631

(1) comes complete with gasket



CEF IMPELLERS



EVINRUDE JOHNSON OUTBOARD ENGINE IMPELLERS

Application	Aquafax Part No.	OE No.
1 1/2, 2 HP (1967-1984)	2-50369	382221
1 1/2, 2 HP (1968-1990)	2-50358	387361
1.6L Seadrives (1982 >)	2-50305	389642
1.6L Seadrives (1982-1994) (except 1987 counter rotation models)	2-50308	397131 435821
10 HP (1949-1957)	2-50351	375638
100 HP (1979>)	2-50305	389642
100 HP (1979-1997)	2-50308	397131 435821
100 HP (Comm) (1984-1997)	2-50308	397131 435821
100C HP (1984>)	2-50305	389642
105 HP JET (1994-1997)	2-50308	397131 435821
110 HP (1986>)	2-50305	389642
110 HP (1986-1993)	2-50308	397131 435821
112 HP (1994-1996)	2-50308	397131 435821
115 HP (1973-1994)	2-50305	389642
115 HP (1979-1997) V models only	2-50308	397131 435821
115 HP (25") (1977)	2-50305	389642
120 HP (1985>) except 25" & 30" models	2-50305	389642
120 HP (1985-1994) except 25" & 30" models	2-50308	397131 435821
125 HP (1971-1972)	2-50305	389642
125 HP (1994-1995) except 25" & 30" models	2-50308	397131 435821
130 HP (1994-1997) except 25" & 30" models	2-50308	397131 435821
135 HP (1973-1996)	2-50305	389642
140 HP (1977-1978)	2-50305	389642
140 HP (1979>) except 25" & 30" models	2-50305	389642
140 HP (1979-1994) except 25" & 30" models	2-50308	397131 435821
15 HP (1956-1973)	2-50351	375638
15 HP (1974-1980)	2-50355	386084
15 HP (1981-1989)	2-50355	386084
15 HP (1990>)	2-50355	386084
150 HP (1976-1978)	2-50305	389642
150 HP (1979>) except 25" & 30" models	2-50305	389642
150 HP (1979-1997) except 25" & 30" models	2-50308	397131 435821
155 HP (1984-) except 25" & 30" models	2-50308	435821
155 HP (1984>) except 25" & 30" models	2-50305	389642
175 HP (1976-1978)	2-50305	389642
175 HP (1979>) except 25" & 30" models	2-50305	389642

Application	Aquafax Part No.	OE No.
175 HP (1979-1997) except 25" & 30" models	2-50308	397131 435821
18 HP (1956-1973)	2-50351	375638
185 HP (1984>) except 25" & 30" models	2-50305	389642
185 HP (1984-1994) except 25" & 30" models	2-50308	397131 435821
2.3L HP Seadrive (1982-1994)	2-50308	397131 435821
2.3L Seadrive (1982 >) (except counter rotation)	2-50305	389642
20 HP (1966-1978)	2-50351	375638
20 HP (1978-1984)	2-50370	395289
20 HP (1985-2002)	2-50370	395289
200 HP (1976-1978)	2-50305	389642
200 HP (1979>) except 25" & 30" models	2-50305	389642
200 HP (1979-1997) except 25" & 30" models	2-50308	397131 435821
225 HP (1986>) except 25" & 30" models	2-50305	389642
225 HP (1986-1997) except 25" & 30" models	2-50308	397131 435821
235 HP (1976-1978)	2-50305	389642
235 HP (1979>) except 25" & 30" models	2-50305	389642
235 HP (1979-1985)	2-50308	397131 435821
25 HP (1966-1978)	2-50351	375638
25 HP (1978-1984)	2-50370	395289
25 HP (1985-2002)	2-50370	395289
25 HP (Comm) (1998-2002)	2-50370	395289
25 HP (old model)	2-50357	388702
25,35 (3cyl) (1995-2002)	2-50370	395289
250 HP (1993-1995) except 25" & 30" models	2-50308	397131 435821
275 HP (1985-) except 25" & 30" models	2-50308	397131 435821
275 HP (1985>) except 25" & 30" models	2-50305	389642
28,14 (Comm) (1985-1997)	2-50370	395289
3 HP (1957-1968)	2-50350	277181 434424
30 HP (1985-1997)	2-50370	395289
30,35 (1980-1982)	2-50370	395289
30,35 (2 cyl) (1983>)	2-50370	395289
300/3.6L HP (1985>) except 25" & 30" models	2-50305	389642
300/3.6L HP (1985-1995) except 25" & 30" models	2-50308	397131 435821
35 (1976-1977)	2-50374	389983
35 (1978-1979)	2-50370	395289
35 HP (1980-1997)	2-50370	395289
35 HP W/Thermostart (1958-1959)	2-50352	377230
4 HP (110 Gearcase) (1973-1983)	2-50350	277181 434424
4 HP (1969-1982) Weedless Drive	2-50350	277181 434424
4 HP (90°) (1973-1980)	2-50358	387361
4 HP (90°) (1981-1990)	2-50354	389576
4 HP (90°) Gearcase (1973-1975)	2-50369	382221
40 HP (1960-1970)	2-50352	377230
40 HP (1974-1976)	2-50353	390286
40 HP (1984-1988)	2-50346	396809



CEF IMPELLERS

Application	Aquafax Part No.	OE No.
40 HP (1989-1994)	2-50372	432941
40 HP comm (1981-1990)	2-50353	390286
40 HP comm (RPRW) (1993-1994)	2-50346	396809
40 HP comm (RPRW) (1995-2002)	2-50373	437059 438592
40 HP comm (RS) (1991-2002)	2-50373	437059 438592
40,48,50 HP (1989-2002)	2-50373	437059 438592
40-50-55-60 HP (1979-1985)	2-50345	389589
45/55 HP comm (1986-1994)	2-50346	396809
45/55 HP comm (1995-2002)	2-50373	437059 438592
48 HP (1987-1988)	2-50346	396809
48 HP (1989-1994)	2-50372	432941
5 HP (1965-1968)	2-50350	277181 434424
5.5 HP (1957-1964)	2-50350	277181 434424
50 HP (1971-1975)	2-50352	377230
50 HP (1986-1988)	2-50346	396809
50 HP (1989-1994)	2-50372	432941
55 HP (1968-1969)	2-50307	382547
55 HP (1971-1978)	2-50352	377230
5-6 HP (1998>) 4 Stroke	2-50354	389576
6 HP (1965-1978)	2-50350	277181 434424
6 HP (1979)	2-50358	387361
60,65 comm, 70 (1995-2002)	2-50373	437059 438592
60-65-70-75 HP (1970-1978)	2-50307	382547
60-65-70-75 HP (1979-1994)	2-50303	396725 432954 437080
60SST HP (1989)	2-50303	396725 432954 437080
65 HP comm (1984-1994)	2-50303	396725 432954 437080
6-8-4, 5-7 HP and 4 Delux (1980)	2-50354	389576
7.5 HP (1957-1958)	2-50350	277181 434424
8,9,9,15 HP 4 Stroke	2-50355	386084
80 HP JET (1993-1996)	2-50308	397131 435821
85 HP (1973-1981)	2-50305	389642
85 HP (25") (1973-1981)	2-50305	389642
85 HP TTL (1993-1995)	2-50308	397131 435821
88 HP (1987-1991)	2-50305	389642
88 HP (1987-1996)	2-50308	397131 435821
9.9 HP (1974>)	2-50355	386084
90 HP (1982-1994)	2-50305	389642
90 HP (1982-1997) V models only	2-50308	397131 435821



2-50369



2-50353



2-50349



2-50373

OMC OUTBOARD & STERN DRIVE ENGINE IMPELLERS

Application	Aquafax Part No.	OE No.
1 1/2 2 HP (1967-1984)	2-50369	382221
2.5L/4.3L/5.0L (all clutch)	2-50317	983895
4 HP (90°) Gearcase (1973-1975)	2-50369	382221
5.7L/3.0L (dog cobra)	2-50317	983895
7.5L (except 2.3)	2-50317	983895
9.5 HP (1964-1973)	2-50349	377178
10 HP (1958-1963)	2-50349	377178
25-30-35 HP (1951-1957)	2-50366	378891
28-33 HP (1962-1971)	2-50366	378891
35 HP (1976-77)	2-50374	389983
40 HP commercial (1981-1990)	2-50353	390286
40-48-50-59-60-65-70 CV (1995>)	2-50373	437059, 438592
85/100 HP (1969-1972)	2-50306	385072
(1968-1985)	2-50356	379475 397475
115 HP (1969-1970)	2-50306	385072
125 HP (1971-1972)	2-50306	385072
Sail Drive	2-50366	378891
Cobra 3.0 U/G	2-50394	986465
4.3/4.3L - 5.01L	2-50103	312781



2-50301



2-50313

MERCURISER STERN DRIVE ENGINE IMPELLERS

Application	Aquafax Part No.	OE No.
8.1S HO	2-50159	47-862232A2
8.1S Horizon	2-50159	47-862232A2
496 MAG (Base Model)	2-50159	47-862232A2
496 MAG (H.O. Model)	2-50159	47-862232A2
Bravo I/II (all)	2-50109	47-59362
Gen II alpha (all)	2-50301	47-43026-T2
I & alpha I (6225577-D469859)	2-50313	47-65960 47-89984
I (2062141-26633441)	2-50313	47-65960 47-89984
I (2663442-6225576)	2-50313	47-65960 47-89984
MC 1 (1684188-2495185)	2-50313	47-65960 47-89984
(1964-1968)		47-89984
MC 1 (2495186-2763441)	2-50313	47-65960 47-89984
(1968-1969)		47-89984
MC 1/R Alpha (2763442-6854392)	2-50313	47-65960
(1970-1984)		47-89984
MR Alpha (6854393-D469858)	2-50313	47-65960 47-89984
(1984-1990)		47-89984

(1) comes complete with gasket



WATER LUBRICATED BEARINGS



We normally stock either Countrose or Icon Polymer water lubricated bearings.

- Approved by Lloyds
- Precision ground inside and outside
- Large range of sizes kept in stock
- Alternative sizes available to special order

Nitrile Liner (or polyurethane as available):

- Outstanding abrasion resistance
- Excellent for water lubrication
- Good noise damping
- More tolerant of misalignment
- Allow greater deflection

Shell:

- Brass Shell (standard naval brass) - tough and durable.
- Phenolic Shell (laminated plastic) - designed to fit in aluminium or steel hulls.

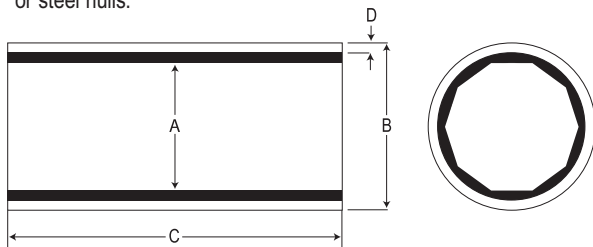

W.M. SERIES

Part Number	Shaft 'dia. A'	Shell 'dia. B'	Length 'C'
2-11290	25mm	34mm	60mm
2-11291	1"	34mm	60mm

Standard Mixed Metric/Inch Series

A Shaft Diameter (mm)	B Outside Diameter	C Standard Length (mm)	D Approx. Metal Thickness	Nitrile Liner		
				Brass Shell	Phenolic Shell	
20	1 1/8"	80	2.4	2-11220	2-11520	TO
22	1 1/8"	88	2.4	2-11222	2-11522	
25	1 1/4"	100	2.4	2-11223	-	
25	1 3/8"	100	2.4	2-11224	-	
25	1 1/2"	100	2.4	2-11225	2-11525	
28	1 5/8"	112	2.4	2-11228	2-11528	TO
30	1 3/4"	120	2.4	2-11230	2-11530	
32	1 3/4"	128	2.4	2-11232	2-11532	TO
35	1 7/8"	140	2.4	2-11235	2-11535	
38	2"	152	2.4	2-11238	2-11538	
40	2 1/8"	160	3.2	2-11240	2-11540	
42	2 3/8"	168	3.2	2-11242	2-11542	TO
45	2 3/8"	180	3.2	2-11245	2-11545	
50	2 1/2"	200	3.2	2-11250	2-11550	
55	2 7/8"	220	2.5	2-11255	2-11555	TO
60	3"	240	3.2	2-11260	2-11560	TO
60	3 1/4"	240	4.0	2-11261	2-11561	TO

Standard Metric Series

A Shaft Diameter (mm)	B Outside Diameter (mm)	C Standard Length (mm)	D Approx. Metal Thickness	Nitrile Liner		
				Brass Shell	Phenolic Shell	
20	35	80	2.4	2-11320	2-11620	
22	35	88	2.4	2-11322	2-11622	
25	40	100	2.4	2-11325	2-11625	
28	42	112	2.8	2-11328	2-11628	TO
30	45	120	2.6	2-11330	2-11630	
32	45	128	2.6	2-11332	2-11632	
35	50	140	2.0	2-11335	2-11635	
38	55	152	3.8	2-11338	2-11638	
40	55	160	3.8	2-11340	2-11640	
42	60	168	3.0	2-11342	2-11642	TO
45	65	180	2.3	2-11345	2-11645	
50	70	200	2.3	2-11350	2-11650	
55	75	220	3.8	2-11355	2-11655	
60	80	240	3.3	2-11360	2-11660	
65	85	260	3.8	2-11365	2-11665	TO
70	90	280	2.3	2-11370	2-11670	
75	95	300	4.0	2-11375	2-11675	
80	100	320	4.2	2-11380	2-11680	TO
85	105	340	4.2	2-11381		TO
90	110	360	4.2	2-11382		TO
95	115	380	4.2			
100	125	400	3.6			
105	130	420	3.6			
110	135	440	4.8			
115	145	460	5.0			
120	155	480	6.0			
125	165	500	6.3			
130	170	520	5.6			
135	170	540	5.6			
140	180	560	7.3			
145	180	580	7.3			
150	190	600	6.1			
155	190	620	6.1			

THESE SIZES TO ORDER ONLY

TO = Part No.s in red are to order only



WATER LUBRICATED BEARINGS

Standard Inch Series

A Shaft Diameter	B Outside Diameter	C Standard Length	D Approx. Metal Thickness	Nitrile Liner	
				Brass Shell	Phenolic Shell
3/4"	1 1/4"	3"	0.11"	2-11101	2-11401
7/8"	1 1/4"	3 1/2"	0.11"	2-11102	2-11402
7/8"	1 3/8"	3 1/2"	0.09"	2-11103	2-11403
7/8"	1 1/2"	3 1/2"	0.09"	2-11104	2-11404
1"	1 1/4"	4"	0.06"	2-11105	2-11405
1"	1 3/8"	4"	0.09"	2-11106	2-11406
1"	1 1/2"	4"	0.09"	2-11107	2-11407
1"	1 5/8"	4"	0.09"	2-11108	2-11408
1"	2"	4"	0.09"	2-11109	2-11409
1 1/8"	1 1/2"	4 1/2"	0.06"	2-11110	2-11410
1 1/8"	1 5/8"	4 1/2"	0.06"	2-11111	2-11411
1 1/8"	1 3/4"	4 1/2"	0.06"	2-11112	2-11412
1 1/8"	2"	4 1/2"	0.06"	2-11113	2-11413
1 1/4"	1 5/8"	5"	0.06"	2-11114	2-11414
1 1/4"	1 3/4"	5"	0.09"	2-11115	2-11415
1 1/4"	2"	5"	0.09"	2-11116	2-11416
1 1/4"	2 1/8"	5"	0.13"	2-11117	2-11417 TO
1 3/8"	1 7/8"	5 1/2"	0.09"	2-11118	2-11418
1 3/8"	2"	5 1/2"	0.09"	2-11119	2-11419
1 3/8"	2 1/8"	5 1/2"	0.13"	2-11120	2-11420 TO
1 3/8"	2 3/8"	5 1/2"	0.13"	2-11121	2-11421 TO
1 1/2"	2"	6"	0.09"	2-11122	2-11422
1 1/2"	2 1/8"	6"	0.13"	2-11123	2-11423
1 5/8"	2 1/8"	6 1/2"	0.13"	2-11124	2-11424
1 5/8"	2 5/8"	6 1/2"	0.13"	2-11125	2-11425
1 3/4"	2 3/8"	7"	0.13"	2-11126	2-11426
1 3/4"	2 5/8"	7"	0.13"	2-11127	2-11427
1 7/8"	2 5/8"	7 1/2"	0.13"	2-11128	2-11428
1 7/8"	2 15/16"	7 1/2"	0.13"	2-11129	2-11429 TO
2"	2 5/8"	8"	0.13"	2-11130	2-11430
2"	2 3/4"	8"	0.13"	2-11131	2-11431
2"	3"	8"	0.13"	2-11132	2-11432
2 1/8"	2 3/4"	8 1/2"	0.13"	2-11133	2-11433 TO
2 1/8"	2 15/16"	8 1/2"	0.13"	2-11134	2-11434 TO
2 1/8"	3 1/8"	8 1/2"	0.13"	2-11135	2-11435 TO
2 1/4"	2 15/16"	9"	0.13"	2-11136	2-11436 TO
2 1/4"	3"	9"	0.13"	2-11137	2-11437
2 1/4"	3 3/8"	9"	0.13"	2-11138	2-11438
2 1/4"	3 3/8"	9"	0.16"	2-11139	2-11439 TO
2 3/8"	3"	9 1/2"	0.13"	2-11140	2-11440 TO
2 3/8"	3 3/8"	9 1/2"	0.13"	2-11141	2-11441 TO
2 3/8"	3 3/8"	9 1/2"	0.16"	2-11142	2-11442 TO
2 1/2"	3"	10"	0.13"	2-11143	2-11443
2 1/2"	3 3/8"	10"	0.13"	2-11144	2-11444
2 1/2"	3 1/4"	10"	0.16"	2-11145	2-11445
2 1/2"	3 3/8"	10"	0.16"	2-11146	2-11446
2 1/2"	3 1/2"	10"	0.11"	2-11147	2-11447
2 3/4"	3 3/8"	11"	0.16"	2-11150	2-11450
2 3/4"	3 1/2"	11"	0.11"	2-11151	2-11451
2 3/4"	3 3/4"	11"	0.16"	2-11152	2-11452
3"	4"	12"	0.19"	2-11156	2-11456
3 1/4"	4"	13"	0.19"	2-11158	2-11458

A Shaft Diameter	B Outside Diameter	C Standard Length	D Approx. Metal Thickness	Nitrile Liner	
				Brass Shell*	
2 5/8"	3 3/8"	10 1/2"	0.16"	2-11148	TO
2 5/8"	3 1/2"	10 1/2"	0.11"	2-11149	TO
2 7/8"	3 1/2"	11 1/2"	0.11"	2-11153	TO
2 7/8"	3 3/4"	11 1/2"	0.16"	2-11154	
3"	3 3/4"	12"	0.16"	2-11155	
3 1/8"	4 1/4"	12 1/2"	0.19"	2-11157	TO
3 1/4"	4 1/4"	13"	0.19"	2-11159	
3 3/8"	4 1/8"	13 1/2"	0.17"	2-11160	TO
3 3/8"	4 1/2"	13 1/2"	0.15"	2-11161	TO
3 1/2"	4 1/4"	14"	0.19"	2-11162	
3 1/2"	4 1/2"	14"	0.15"	2-11163	
3 5/8"	4 1/2"	14 1/2"	0.15"	2-11164	TO ORDER ONLY
3 3/4"	4 1/2"	15"	0.15"	2-11165	TO ORDER ONLY
3 3/4"	5"	15"	0.19"	2-11166	TO ORDER ONLY
3 3/4"	5 1/4"	15"	0.21"	2-11167	TO ORDER ONLY
3 7/8"	5 1/4"	15 1/2"	0.21"	2-11168	TO ORDER ONLY
4"	5"	16"	0.15"	2-11169	TO ORDER ONLY
4"	5 1/4"	16"	0.21"	2-11170	TO ORDER ONLY
4 1/8"	5 1/4"	16 1/2"	0.21"	2-11171	TO ORDER ONLY
4 1/4"	5 1/4"	17"	0.21"	2-11172	TO ORDER ONLY
4 1/4"	5 1/2"	17"	0.19"	2-11173	TO ORDER ONLY
4 3/8"	5 3/4"	17 1/2"	0.25"	2-11174	TO ORDER ONLY
4 1/2"	5 1/2"	18"	0.19"	2-11175	TO ORDER ONLY
4 1/2"	5 5/8"	18"	0.25"	2-11176	TO ORDER ONLY
4 1/2"	5 3/4"	18"	0.25"	2-11177	TO ORDER ONLY
4 5/8"	6 1/8"	18 1/2"	0.25"	2-11178	TO ORDER ONLY
4 3/4"	6"	19"	0.25"	2-11179	TO ORDER ONLY
4 3/4"	6 1/8"	19"	0.25"	2-11180	TO ORDER ONLY
4 7/8"	6 1/8"	19 1/2"	0.25"	2-11181	TO ORDER ONLY
5"	6 1/8"	20"	0.25"	2-11182	TO ORDER ONLY
5"	6 1/4"	20"	0.21"	2-11183	TO ORDER ONLY
5"	6 1/2"	20"	0.25"	2-11184	TO ORDER ONLY
5 1/4"	6 3/4"	21"	0.28"	2-11185	TO ORDER ONLY
5 1/4"	7"	21"	0.25"	2-11186	TO ORDER ONLY
5 3/8"	6 3/4"	21 1/2"	0.28"	2-11187	TO ORDER ONLY
5 3/8"	7"	21 1/2"	0.25"	2-11188	TO ORDER ONLY
5 1/2"	7"	22"	0.25"	2-11189	TO ORDER ONLY
5 5/8"	7"	22 1/2"	0.25"	2-11190	TO ORDER ONLY
5 3/4"	7"	23"	0.25"	2-11191	TO ORDER ONLY
5 7/8"	7 1/2"	24"	0.25"	2-11192	TO ORDER ONLY
6"	7 1/2"	14"	0.25"	2-11193	TO ORDER ONLY

*Also available with phenolic shell

TO = Part No.s in red are to order only



PSS SHAFT SEALS



The PSS Shaft Seal uses the highest quality materials and manufacturing procedures to give a drip free performance with zero wear to the propeller shaft and the capability of operating safely up to 500°F.

They require no lubrication other than water. A fitting is provided on the carbon flange to accept a feed from the engine's water exhaust to assist cooling.

Features:

- Dripless operation
- Maintenance free
- Eliminates shaft wear
- No mess or corrosion
- **3 Year guarantee**
- ABS approved
- Over 100,000 in successful operation
- Suitable for leisure & commercial craft
- Unaffected by engine movement or vibration
- Manufactured in the USA
- Metric & imperial sizes for shafts from 20mm - 3/4" to 100mm - 4"
- The carbon/graphite flanges & rotor should never need replacing under normal operating conditions

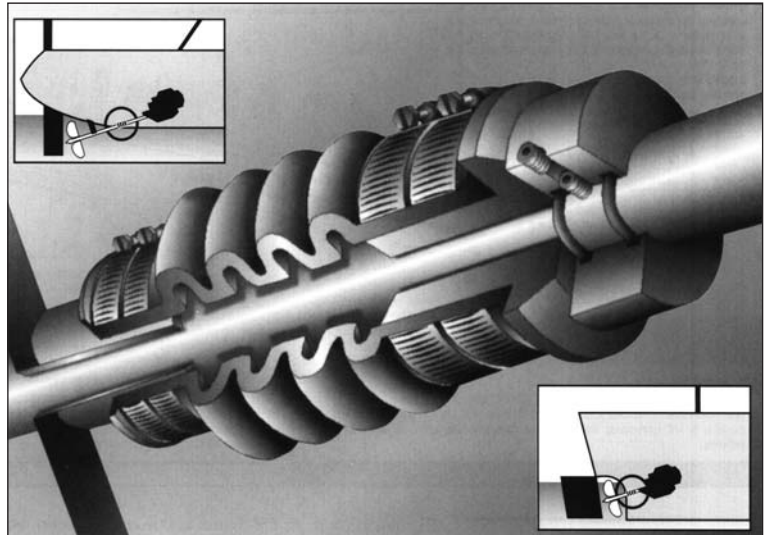

Technical Specifications:

- **High Density Carbon Graphite Flange**
Once installed and operational the carbon/graphite face will polish the stainless steel rotor during the initial first few minutes of operation ensuring a perfect fit thus eliminating any drips or spray. The ultra dense carbon/graphite composite has a maximum operating temperature of 500°F, guarding against failure by over heating as can occur on rubber and plastic based seals.
- **Stainless Steel Rotor**
The one-piece, 316 grade stainless steel rotor is secured to the propeller shaft with double set screws. The twin nitrile 'O' rings are stationary and do not wear.
- **Reinforced Bellows**
The heavy reinforced nitrile bellows are resistant to petroleum based products and retain their preset dimensions. They provide the best combination of durability, strength and elasticity.

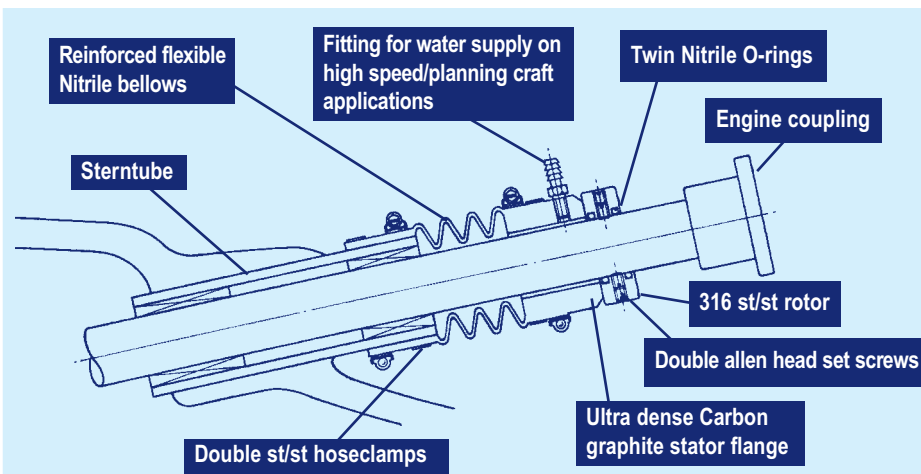

THE PRINCIPLE

The seal is created by contact of the carbon face against the rotating stainless steel rotor. A hydrodynamic bead of water between the carbon seal and rotor provides lubrication. The carbon seal and rotor provides lubrication. The carbon seal and bellows assembly is fitted to the stern tube by twin stainless hose clamps. Contact with the rotor is assisted by water pressure which helps to cool the assembly. Seal contact is unaffected by engine laterally or fore and aft.

Waterlocks/Silencers & Exhaust Hose



Aquafax

WATERLOCKS/SILENCERS & EXHAUST HOSE

WATERLOCK / SILENCER

Part No.	Hose Size (mm)	Max Engine HP	Litres	Dimensions (mm)				
				A	B	C	D	E
2-05051	40/45/50	50HP	7L	See drawing details				
2-05052	55/60/65	115HP	20L	640	225	320	285	230
2-05054	75/90	150HP	33L	780	280	410	350	270
2-05055	100/115	300HP	33L	780	280	410	350	270



ANTI SYPHON GOOSENECK

Supplied with plastic fixing straps

Part No.	Description
2-05005	90° 40/45/50mm Hose
2-05006	45° 40/45/50mm Hose

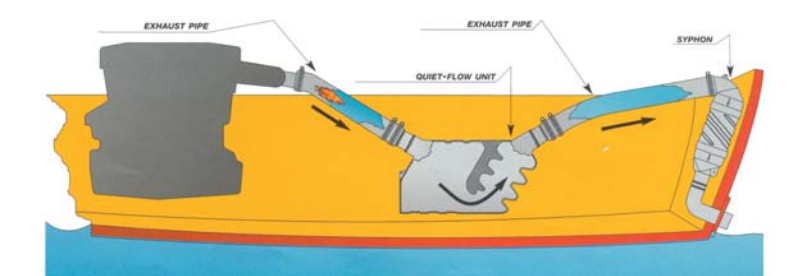
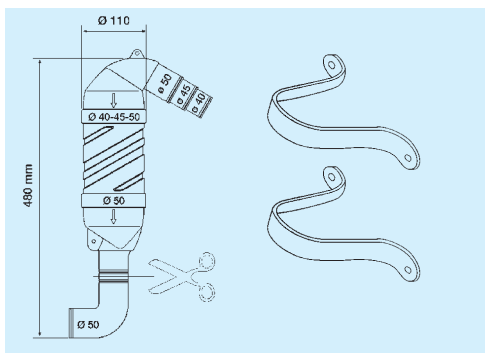
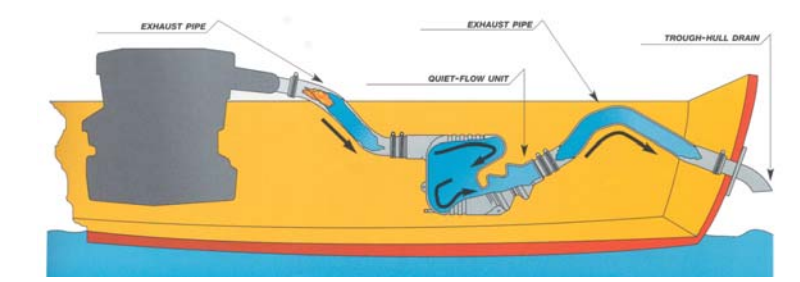
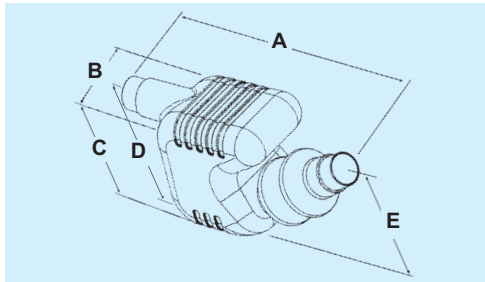
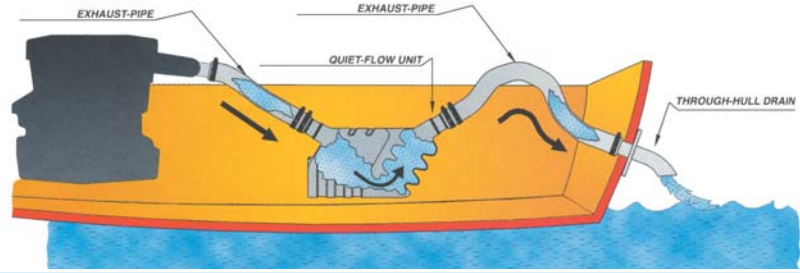
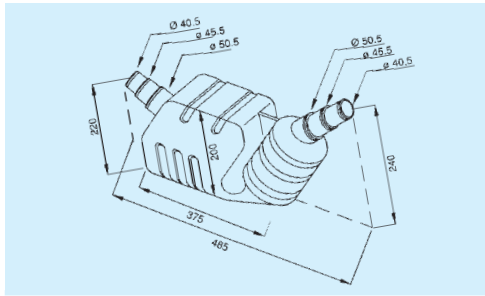

- Lloyds approved • Vacuum: 0.8 Bar • See Section 1 for JCS Hi-Torque Hose Clamps
- Lining: Black, exhaust gas, salt water resistant EPDM rubber
- Reinforcement: Synthetic textile fabrics and double steel helix wire
- Cover: with black corrugated, resistant to heat, salt water, ozone, ebrasion, EPDM rubber

EXHAUST HOSE

Other sizes and lengths may be available to special order



ID (approx) mm	Inch	OD (approx) mm	Working Pressure		Burst Pressure		Bend Radius mm	Weight kg/m	10m Part No.	20m Part No.
			Bar	PSI	Bar	PSI				
32	1¼"	41	4	58	12	174	64	0.835	2-04032	-
38	1½"	47	4	58	12	174	76	0.975	2-04038	-
40	1⅝"	49	4	58	12	174	80	1.024	2-04040	-
45	1¾"	54	4	58	12	174	90	1.228	2-04045	-
51	2"	60	4	58	12	174	102	1.273	2-04051	2-04051-2
57	2¼"	66	3.3	47.85	10	145	114	1.411	2-04057	-
63	2½"	72	3.3	47.85	10	145	126	1.530	2-04063	-
76	3"	85	3.3	47.85	10	145	152	1.808	2-04076	2-04076-2
90	3½"	99	2	29	6	87	180	2.553	2-04090	-
102	4"	111	2	29	6	87	204	2.917	2-04102	✗
127	5"	137	2	29	6	87	254	3.613	2-04127	✗
152	6"	163	2	29	6	87	304	4.683	2-04152	✗



DELIVERY

Check availability, delivery costs & methods available may be subject to a surcharge.



EXHAUST FITTINGS

TRANSOM FITTINGS

Made in 316 Stainless Steel with 6mm ID fixing holes and ribbed hose tails. Available in straight and 45° variation with either trumpet or angled outlets.



ANGLED OUTLET
Inlet straight

Hose Size	Part No.
40mm	2-00540A
45mm	2-00545A
51mm	2-00551A
57mm	-
63mm	2-00563A
76mm	2-00576A
89mm	2-00589A
101mm	2-00601A
124mm	2-00624A
154mm	2-00626A



TRUMPET SHAPED OUTLET
Inlet straight

Hose Size	Part No.
40mm	2-00540T
45mm	2-00545T
51mm	2-00551T
57mm	2-00557T
63mm	2-00563T
76mm	2-00576T
89mm	2-00589T
101mm	2-00601T
124mm	-



ANGLED OUTLET
45° fitting

Hose Size	Part No.
40mm	2-00640A
45mm	2-00645A
51mm	2-00651A
57mm	2-00657A
63mm	2-00663A
76mm	-
89mm	-
101mm	2-00701A
124mm	2-00724A



TRUMPET SHAPED OUTLET
45° fitting

Hose Size	Part No.
40mm	2-00640T
45mm	2-00645T
51mm	2-00651T
57mm	-
63mm	2-00663T
76mm	2-00676T
89mm	-
101mm	2-00701T
124mm	2-00724T

CONNECTING TUBES

Made in 316 Stainless Steel with ribbed ends in straight, 45° and 90°.



Straight connector

Hose Size	Part No.
40mm	2-00040
45mm	2-00045
51mm	2-00051
57mm	2-00057
63mm	2-00063
76mm	2-00076
89mm	-
101mm	2-00101
124mm	2-00124
154mm	2-00126



Connector 45°

Hose Size	Part No.
40mm	2-00140
45mm	2-00145
51mm	2-00151
57mm	2-00157
63mm	2-00163
76mm	2-00176
89mm	2-00189
101mm	-
124mm	2-00224
154mm	2-00226



Connector 90°

Hose Size	Part No.
40mm	2-00340
45mm	2-00345
51mm	2-00351
57mm	2-00357
63mm	2-00363
76mm	2-00376
89mm	2-00389
101mm	2-00401
124mm	2-00424
154mm	-



GLASS FIBRE WOVEN TAPE

Suitable for exhaust systems. Fire proof. Temperature resistant to 550°C. Good thermal and acoustic insulation. Excellent chemical resistance. Retains shape, non water absorbant.

Width	Thick	Length	Part No.
50mm	3mm	30m	2-03001
50mm	3mm	5m	2-03001/5U
75mm	3mm	30m	2-03003
75mm	3mm	5m	2-03003-5V

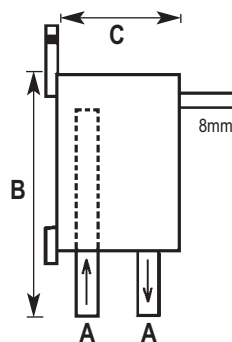

ANTI-SYPHON UNITS

Manufactured in 316 Stainless Steel these simple but effective units are valve free. Available in two body sizes of which the four large ones come fixed with securing brackets and the two small ones with separate securing straps.

Part No.	Hose Size (A)	Height (B)	Dia. (C)	Outlet
2-00013	13mm	130mm	50mm	8mm
2-00016	16mm	130mm	50mm	8mm
2-00019	19mm	195mm	85mm	8mm
2-00025	25mm	195mm	85mm	8mm
2-00032	32mm	195mm	85mm	8mm

They are designed to work in conjunction with the waterlock fitted with syphon outlet. As soon as the engine stops air rises from the waterlock to break the syphon effect. Alternatively they can be piped to overboard fittings.



MORRIS LUBRICANTS



SERVOL PERFORMANCE PLUS 15W/40

APPLICATION:

- High quality mineral oil designed for use in modern petrol, diesel and turbo charged engines.

PERFORMANCE:

- Provides a high level of engine cleanliness and controls the formation of high temperature lacquers and low temperature sludges
- Contains an effective dispersant to minimise oil thickening



API: CG-4/CF-4/SJ/SL TBN, mg/KOH/g: 11.0

Part No. 2-74924 Bulk Pack 4 x 5L plastic bottles

Part No. 2-74924/1 Single 5L plastic bottle

GOLDEN FILM SAE 30 (formerly 'Supreme 30')

APPLICATION:

- Golden film SAE 30 is an ideal choice for lightly loaded older diesel engines used in canal boats, watercraft and generators e.g Lister and Perkins

PERFORMANCE:

- Recommended for use in engines where modern multigrade, high additive level oils cannot be used. Can dramatically reduce the likelihood of bore glazing.



API: CC/SD TBN, mg/KOH/g: 4.0

Part No. 2-74923 Bulk Pack 4 x 5L plastic bottles

Part No. 2-74923/1 Single 5L plastic bottle

AQUAMAX 2 STROKE OUTBOARD OIL

APPLICATION:

Recommended for two stroke water cooled outboard engines using premix or oil injection, from high powered down to small cylinder auxiliary engines.

PERFORMANCE:

Aqua Max 2 has been developed to meet the need for a specialised ash free outboard motor oil for today's high powered multi cylinder two cycle engines. The formulation provides an excellent lubricating film giving an improved engine performance and reduces engine wear.

- Maximum film strength
- Freedom from ring sticking
- No plug fouling or pre-ignition
- Anti-wear, anti-scuffing protection
- Reduced smoke and clean burning characteristics
- Reduced deposit formation in ports

Physical Characteristics

Colour	Blue/Purple
TBN, mg/KOH/g:	4.5



Certified by: National Marine Manufacturers Association (NMMA): TC-W3™ R-94102B JASO FB

Description	Part No.	Description	Part No.
Bulk Pack 12 x 1Lt	2-74934	Bulk Pack 4 x 4Ltr	2-74935
Single 1Ltr Bottle	2-74934/1	Single 4Ltr Container	2-74935/1

K2EP LONGLIFE GREASE

APPLICATION:

The high degree of water tolerance makes K2EP ideal for boat trailer bearings, where there is a combination of immersion and high speed road work.

PERFORMANCE:

K2EP is a mineral oil based, lithium complex, soap-thickened grease, containing performance additives. The additives provide extreme pressure (EP), oxidation, rust and corrosion protection, ensuring effective lubrication is achieved even under the most severe conditions. It has excellent sealing properties which help protect bearings against corrosive atmospheres and the ingress of water, dust and abrasive particles. This grease out performs conventional Lithium greases at high temperatures.

Suitable for all general industrial, automotive and any bearing requiring long life high performance



Physical Characteristics

Appearance:	Red Sparkle, Tacky
NLGI:	2
Thickener:	Lithium Complex
Operating Temp Range:	-20°C to +150°C

Part No.
2-74915 400g cartridge
2-74916 12.5kg Tub



K99 WATER RESISTANT GREASE

APPLICATION:

Specially designed by Morris to feed evenly around the propeller shaft in the stern tube.

PERFORMANCE:

Outstanding water resistance qualities providing excellent protection of parts from corrosion and has good sealing properties.

Physical Characteristics

Appearance:	Light Brown Smooth Grease
NLGI:	2/3
Operating Temp Range:	-20°C to +110°C

Part No. 2-74911 500gm Tub
Part No. 2-74912 3kg Tub
Part No. 2-74913 12.5kg Tub



DELIVERY

Unable to send via usual carriers. Please contact your local Aquafax sales depot for method & despatch price



MORRIS LUBRICANTS



MORRIS UNIVERSAL ANTI-FREEZE

APPLICATION:

Recommended for all year round use, Universal Antifreeze protects all water cooled engines from frost damage down to -34°C and ice damage -50°C (at 50% of total coolant).

PERFORMANCE:

- Protects against corrosion and prolongs life of metals found in engine cooling system including cast iron, aluminium, copper alloys, solder and other metals
- Does not form sediment, precipitate additives or form gels that can prematurely block the cooling system
- Does not affect rubber hoses or gasket materials
- Lasts two years in service when solution is maintained at 50%
- Does not form harmful foam inside cooling system
- Does not contain silicates

Description

Bulk pack of 12 x 1Lt bottles	Part No. 2-74970
Single 1Lt bottle	2-74970/1
Bulk pack of 4 x 5Lt bottles	2-74972
Single 5Lt container	2-74972/1



Physical Characteristics

Colour:	Blue
Type:	Ethylene Glycol
Meets Standard:	BS6580:1992

Solution Vol	Freezing Point	Boiling Point	SG Reading
25%	-12°C	103°C	1.039
33%	-20°C	104.5°C	1.057

SUPERCLEAN MORENDO DD DIESEL FUEL ADDITIVE

A multifunctional diesel fuel additive that will improve ignition quality, combustion and storage of distillate fuels. It is designed to be added to diesel and distillate burner fuels in bulk storage tanks, or to the fuel tanks of diesel engine vehicles and marine craft.



- Increased Cetane number
- Improved Lubricity
- Injector cleanliness
- Improved dispersancy
- Improved fuel stability
- Water tolerance
- Foam Control

Bulk Pack of 12 x 500ml	Part No. 2-74998
Single 500ml bottle	Part No. 2-74998/1

Physical Characteristics

Colour:	Amber
Treatment Rate:	1 part Superclean Morendo DD to 400 parts fuel

SUPERBLEND ZERO LEAD 2005

A lead free fuel treatment, developed to protect against valve seat recession in 4-stroke engines designed to run on leaded petrol. It is a carefully balanced blend of potassium based organic compounds, that provided enhanced lubricity and wear protection previously attributed to leaded additives. The product does not increase particulate emissions or affect fuel consumption. It is catalytic converter friendly and will not contribute to inlet valve sticking or spark plug fouling.



IT SHOULD NOT BE USED IN CONJUNCTION WITH OTHER FUEL ADDITIVES

Bulk Pack of 12 x 500ml	Part No. 2-74999
Single 500ml bottle	Part No. 2-74999/1

Physical Characteristics

Colour:	Amber
Treatment Rate:	1 part Superblend Zero Lead 2005 to 300 parts fuel

INSULATION

SOUNDPROOF INSULATION FOAM

Designed for boat engine rooms. The reinforced foil faced (oil and tear resistant) laminated acoustic barrier foam is basically non-combustible and meets ISO 9094 of the recreational craft directive. In fact it is to the highest rating (zero) of the fire retardant requirement of BS476 Part 6 and 7.

Approx. Dimensions	Part No.
30mm thick 1m x 0.6m	2-22993
30mm thick 1m x 1.20m	2-22994
30mm thick 2m x 1.20m	2-22995

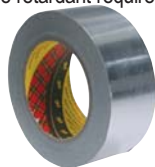

3M 1436 ALUMINIUM FOIL JOINTING TAPE
50m x 50mm **Part No. 7-01436/1**

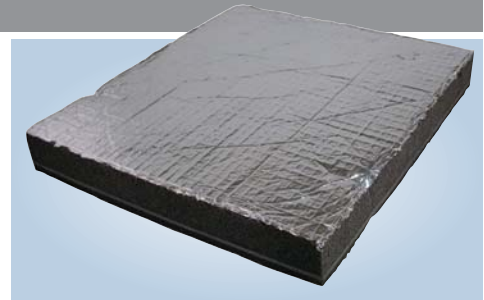

K-FLEX LLOYDS APPROVED PIPE INSULATION

- Suitable for re Fridgeration, air-conditioning, heating, water pipes etc.
- O Fire rating BS 476 P 6/7 1989
- Lloyds approved product
- Temperature range of -200°C max to + 116°C
- Highly flexible non-slit 2M lengths
- Stocking 19mm and 25mm wall thicknesses on most common pipe sizes



Part No.	Description
2-23014	15mm ID, 9mm wall, 2m
2-23035	22mm ID, 19mm wall, 2m
2-23036	28mm ID, 19mm wall, 2m
2-23038	35mm ID, 19mm wall, 2m
2-23039	42mm ID, 19mm wall, 2m
2-23041	54mm ID, 19mm wall, 2m
2-23055	42mm ID, 25mm wall, 2m
2-23056	48mm ID, 25mm wall, 2m

OTHER SIZES AVAILABLE TO ORDER



FUEL FILTERS

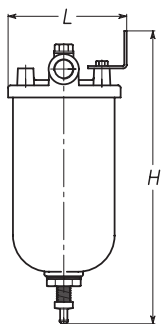

DIESEL FUEL STRAINER

Diesel fuel pre-filter with removable fine 80 micron perforation S/S gauze, washable, in steel body.
Features: bleed valve, drain valve, L/H or R/H mounting bracket.

Thread	Capacity	Dimensions	Part No.
M14 x 1.5	90 LPH	H=215mm L=95mm	2-76950



2-76939



2-76931

FUEL FILTERS – UNF THREAD CONNECTIONS

Lucas / Cav type unit with common replacement paper cartridge filter. Bulkhead mounting. Either hand. Fitted with metal drain tap. 2-76931 has spin cartridge.

Thread	Capacity	Type	Length OA	Width	Depth	Part No.
1/2" UNF	45 LPH	Bolt-on	165mm	100mm	90mm	2-76939
1/2" UNF	45 LPH	Spin-on	190mm	100mm	85mm	2-76931

FUEL FILTERS – METRIC THREAD CONNECTIONS

Single fuel filter with settling bowl and bleed screw complete with interchangeable cartridge for engine max 3500cc. Capacity 50 LPH



2-76937



2-76938

Thread	Bowl	Length OA	Width	Depth	Part No.
M14x1.5	Metal	165mm	100mm	90mm	2-76937
M14x1.5	Transparent Plastic	180mm	100mm	90mm	2-76938

FUEL FILTER KITS

Part No. Description

- 2-76943 Straight Connector Kit - 8mm Hose
- 2-76944 Straight Connector Kit - 10mm Hose
- 2-76948 Swivel Connector Kit - 8mm Hose
- 2-76949 Swivel Connector Kit - 10mm Hose

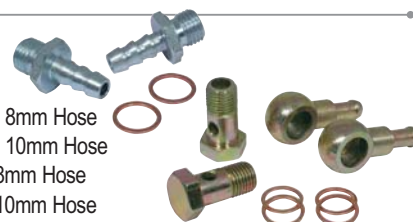

STUD COUPLINGS TO FIT FUEL FILTERS

- 1-14210 M14 x 1.5 Stud Coupling 1/4" Copper Pipe
- 1-14211 M14 x 1.5 Stud Coupling 5/16" Copper Pipe
- 1-14212 M14 x 1.5 Stud Coupling 3/8" Copper Pipe



FUEL FILTER ACCESSORIES

- 2-76933 Replacement Spin-On Cartridge (496A) for 2-76931 filter
- 2-76941 Replacement Cartridge Filter for 2-76937 & 2-76938 & 2-76939
- 2-76942 Replacement Metal Drain Plug for 2-76939
- 2-76945 1/2" UNF Compression Fitting for 1/4" OD Tube
- 2-76946 1/2" UNF Compression Fitting for 5/16" OD Tube
- 2-76947 1/2" UNF Compression Fitting for 3/8" OD Tube

FUEL FILTER CARTRIDGE

- More resistant to corrosion if exposed to the elements than standard model
- Fits our 2-76937/38/39 filter assemblies
- Standard filter cartridge for CAV filter heads used on many marine engines



Part No. 2-76941B

DIESEL FUEL STRAINER/DECANTER



- For pre engine filter installation
- Robust, cast bronze nickel plated body
- Two separate connected chambers each having S/S filters of different size mesh which are easily removeable for cleaning and re-use
- Body and lid: Plated Cast tonval ATD. 3 base fixing lugs
- Lid secured by four S/S bolts and sealed with nitrile 'O' rings above each chamber
- Inlet/Outlet: BSP Parallel Female
- First Strainer: AISI 316L with mesh of 9 holes to Linear C.M.
- Second strainer: AISI 316L with mesh of 14 holes to Linear C.M.
- Fitted with drain plug to each chamber.

1/2" Inlet/Outlet 2.5L capacity/flow 1400 LPH Part No. 2-76961

Part No.	Size	Dimensions			Flow Rate Capacity through		
		G	H	H1	L	0.1 bar	1 bar
2-76961	1/2"	216	155	262		1650LPH	5340LPH

	1/2
A	217
L	250
H	205
h	130

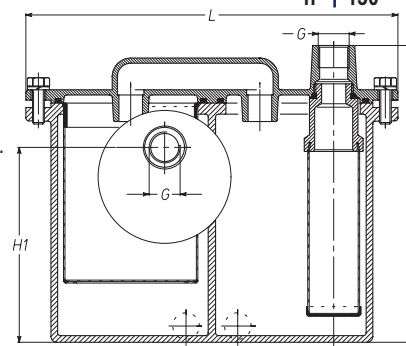



GREASERS/LUBRICATORS

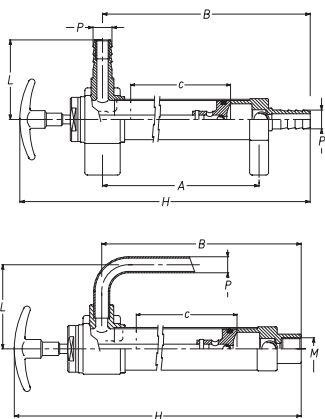
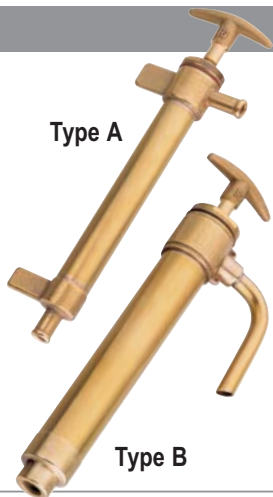

SUMP PUMPS

- Heavy brass barrel and cast barrel ends, and handle.
- Internal brass piston with 'O' ring and ball in cage valve.
- Inlet/outlet for 1/2" (12mm) I.D. hose.

Type A - Undrilled fixing lugs

Type B - Outlet pointing down & threaded M14 x 1.5 inlet

Part No.	Barrel ID	Barrel Capacity	C	H	A	P	B	L	Type
2-74589	3/4"	51cm ²	125	255	165	13	194	38	A
2-74590	1"	100cm ²	190	335	230	15	273	66	A
2-74595	1"	96cm ²	140	270	-	12	205	70	B

1/2" Hose Connector M14 x 1.5

1-77210

5/16" Copper Pipe Connector M14 x 1.5

1-14211

PATAY SUMP PUMP

Passivated steel, capacity 77cc per stroke.
Commonly fitted by UK engine manufacturers.



Dimensions

Height (closed):	240mm
Height (extended):	335mm
Barrel Diameter:	32mm
Spout Projection:	75mm
Inlet:	3/8" BSP Male

Part No. 2-22380 (pump only)

Part No. 2-22381 (pump with mounting clips)

Suction tube assembly available to order.

SUMP PUMPS

A simple & convenient solution to changing oil, especially on engines with in-accessible drain plugs.
Also ideal for transferring diesel between tanks or to fill small day tanks.

External Thread: 1/2" BSP

Internal Thread: 1/4" BSP

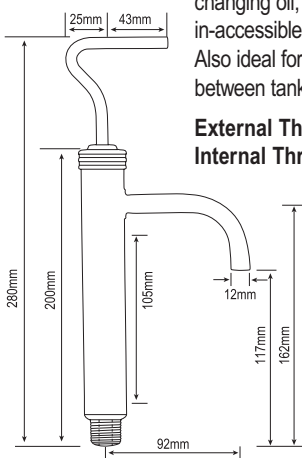

No tube
P/No. 9-42952



With 15" x 1/4"
copper tube
P/No. 9-42953

QUICK RELEASE BRASS GREASER

Brass lubricator for stern tubes, rudder bearings etc.
Bulkhead or floor mounted. Capacity: 150ml (5fl oz.).
Quick Release Brass Greaser Part No. 2-74905

Dimensions:	2-74905
Base width:	80mm (3 1/8")
Projection:	70mm (2 3/4")
Base height:	27mm (1")
Outlet at base front:	1/8" BSP threaded
OA height extended:	288mm
OA height closed:	178mm



GLAND PACKING

Made from quality yarn impregnated with petroleum jelly & coated with flake graphite prior to plating. Suitable for stern glands, pumps etc.
Supplied as 8m length or if possible carded.



Section	8m Part No.	Carded Part No.
1/4" (6.5mm)	2-03005	2-03005/1Y (0.5m)
5/16" (8mm)	2-03006	2-03006/1Y (0.5m)
3/8" (10mm)	2-03008	2-03008/1W (1m)
1/2" (13mm)	2-03009	-
3/4" (20mm)	2-03011	-

LUBRICATOR KIT

(Parts only): Consisting of 2 x 1/8" BSP connectors, 1 x 1/4" BSP connector & 3m nylon hose in polythene bag
Part No. 2-74910P

Accessories:	Part No.
Semi rigid high pressure nylon tubing. 5/16" O.Dia per 30m coil	1-51043
1/8" BSPT brass compression connector for nylon tube	1-14095
1/4" BSPT brass compression connector for nylon tube	1-14105
5/16" O.D. Copper tube, annealed, 20g 10m coil	1-50041
5/16" O.D. Copper tube, annealed, 20g 30m coil	1-50043
1/8" BSPT brass connector for 5/16" OD copper tube	1-14090
1/4" BSPT brass connector for 5/16" OD copper tube	1-14100

GREASE CUPS

"Stauffers" type grease cups in hot stamped brass.



Male BSP	Dia.OA	Max Height (approx)	Part No.
1/8"	18mm	29mm	2-74800
1/8"	33mm	40mm	2-74802
1/4"	33mm	40mm	2-74803
1/4"	40mm	42mm	2-74804

DECK FILLERS & FITTINGS



PUMP OUT DECK FITTING

- Fits 1½" or 2" Hose
- Includes 1 x 2-76802 key
- Pump Out symbol complies with ISO 4567 & BS 7162
- 2-76802 Spare Plastic Pump Out/Deck Filler Key

H	H1	H2	H3	D	D1	D2	d	P	G	Brass	Chrome
120	6	31	44	100	51	60	30	38	1½"	2-76800	2-76801

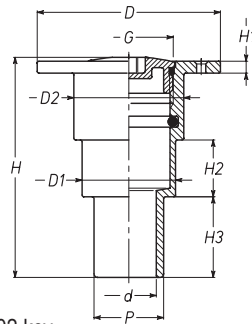

S/S PUMP OUT FITTING

- Highly polished 316 grade stainless steel cap and deck flange
- Plastic 1½" hose tail to suit standard 1-90008C sanitation hose
- Plastic key included

Specifications:	
Overall Diameter:	99mm
Aperture Diameter:	64mm
Holes:	4 x 5.5mm c/sk holes
Height:	125mm



NEW

Part No. 2-76779



RINSE OUT DECK FITTING

- Cast brass deck fitting for ¾" (19mm) I.D. hose
- Cap fitted with 'O' ring & ⅜" AF key slot
- Body is tapered inside to grip shore filler hose
- Supplied with name plate and key

Dimensions:	
Flange dia. O.A.:	74mm
Deck aperture:	45mm
Depth:	72mm

Legend	Brass	Chrome
Rinse Out	2-76782	2-76783



DECK FILLERS

- Cast brass deck fitting for 1½" BSP with plastic hose tails
- Slotted cap fitted with 'O' ring
- Name plate and key supplied
- Accepts 38mm (1½"), 50mm (2") or 63mm (2½") hose
- Hose tail material has a V2 fire rating, test to UN94 & suitable for UK BSS compliance

Dimensions:	
Flange dia.:	100mm
Deck aperture:	63mm
Depth:	78mm

Legend	Brass	Chrome
Water	2-76784	2-76785
Diesel	2-76786	2-76787
Petrol	-	2-76789

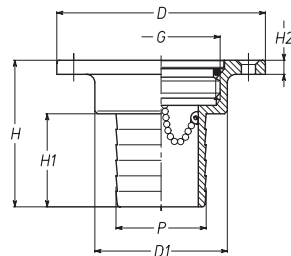

DECK FILLERS

- Hot stamped brass body and cap with Neoprene 'O' ring seal
- Slotted cap and three c/sk holes.

P/Hose	H	H1	H2	D1	D	G	Legend	Brass	Chrome
38mm (1½")	65	45	5	54	83	1½"	Diesel	2-76700	2-76705
38mm (1½")	65	45	5	54	83	1½"	Water	2-76710	2-76715
50mm (2")	65	46	5	54	83	1½"	Diesel	2-76720	2-76725
50mm (2")	65	46	5	54	83	1½"	Water	2-76730	2-76735

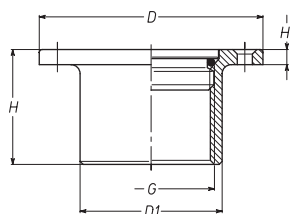

DECK FILLERS

- Hot stamped brass body and cap with Neoprene 'O' ring seal
- Slotted cap and three c/sk holes
- Use hose connectors to adapt deck fillers to suit different hose sizes.

G*/BSP	H	H1	D	D1	Legend	Brass	Chrome
1½"	48	5	83	54	Diesel	2-76770	2-76773
1½"	48	5	83	54	Water	2-76772	2-76775

G* Thread: BSP ISO 228/1 (BS 2779) (DIN 259)

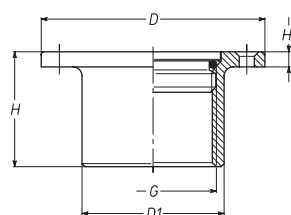

DECK PLATES

- Cast Bronze. Machined. Flange finish with 'O' ring sealed cap
- Supplied with key

G*/BSP	H	H1	D	D1	ID	Spare Key	Part No.
2"	45	6	108	70	56	2-76898	2-76890
2½"	50	6	130	83	72	2-76899	2-76891
3½"	56	6	175	112	97	2-76899	2-76893
5"	35	9	210	150	135	2-76899	2-76895

G* Thread: BSP ISO 228/1 (BS 2779) (DIN 259)



DECK FILLERS & FITTINGS



DECK FILLERS

- Moulded in nylon and resistant to diesel
- Cap is slotted for plastic key supplied
- Cap secured by c/p brass ball chain
- O.A. dia. 95mm
- Bodies and caps available in different colours for fuel or water

Spares	Part No
Spare Key	3-85940
White Filler Cap (Water)	3-85941
Blue Filler Cap (Water)	3-85942
Red Filler Cap (Diesel)	3-85943
White Filler Cap (Diesel)	3-85944

DIESEL

Body	Cap	Legend	Hose	Part No.
White	White	Diesel	1½"	3-85910
White	Red	Diesel	1½"	3-85912
White	White	Diesel	2"	3-85920
White	Red	Diesel	2"	3-85922

WATER

Body	Cap	Legend	Hose	Part No.
White	White	Water	1½"	3-85911
White	Blue	Water	1½"	3-85913
White	White	Water	2"	3-85921
White	Blue	Water	2"	3-85923



PUMP OUT FITTING

Designed for closed toilet systems and the nozzle from shore pump out stations. Moulded in black nylon and c/w key. Cap is fitted with ⅜" hex, socket for opening with special key supplied.

O.A. Dia: 3¾" (95mm)
Deck aperture: 54mm

For 1½" Hose	Part No. 3-85955
Spare Key	Part No. 3-85959
Spare cap black	Part No. 3-85957

DECK DRAIN

- Countersunk brass c/w backnut, securing lugs
- Also suitable for skin fitting
- No grating
- No slot

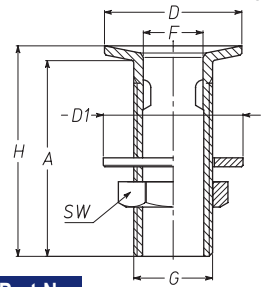

BSP	SW	H	A	F	D	D1	Part No.
⅜"	23	57	53	12	30	33	2-68090
½"	26	65	60	15	35	38	2-68091
¾"	32	70	65	20	46	48	2-68092
1"	38	85	80	25	52	55	2-68093
1¼"	49	86	80	33	61	64	2-68094
1½"	56	95	90	39	68	72	2-68095
2"	68	107	100	50	82	88	2-68096
2½"	92	128	122	63	108	112	2-68097



PLASTIC UNEQUAL HOSE CONNECTOR (13 - 38mm Hose)

The connector is stepped and can be cut to join many hose sizes. Hose increments are: 13mm, 16mm, 19mm, 22mm, 25mm, 28mm, 32mm and 38mm.



Part No. 9-96979

FUELOCK PLASTIC LOCKABLE DIESEL FILLER CAP

With increasing costs of fuel, theft from fuel tanks has increase and more boat owners are looking to make fuel tanks secure.



- Available in 1¼" BSP and 1½" BSP
- Supplied with multi fixing adapter flange fitting a wide range of existing deck fillers & two keys
- Self-closing lock cover keeping the elements out of the locking mechanism
- Marked 'DIESEL' or 'PETROL' (1½" only) on filler cap for BSS and RCD
- 1½" suitable to fit 2-76720/25/70/73 and 86 deck fillers

Size	Type	Part No.
1½" BSP	PETROL	2-76693
1¼" BSP	DIESEL	2-76695
1½" BSP	DIESEL	2-76696

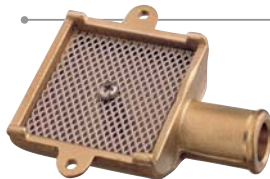

STRUM BOX

Cast in Brass with stainless steel gauze. 2 hole fixing.

P/Hose ID	F	L	Part No.
20mm (¾")	64	82	2-74565
25mm (1")	89	110	2-74566

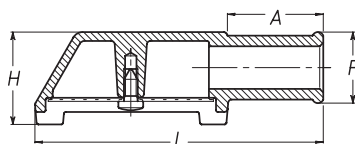
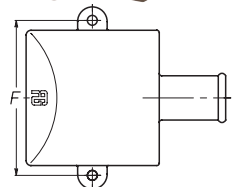

ANTI SPLASH BACK

CAN-SB Anti-Foam directly connected to the deck filler, stops the foam and fuel escaping during the filling of the tank and draws them back into the body of the Anti-Foam, converting the foam into liquid and sending it to the tank.

Comes with 2 rubber adaptors (38mm and 50mm dia.) complete with clamp to connect the deck filler.

Anti-foam can be connected to the tank with a 38mm or 50mm hose connector (see pages 40-41)

Part No. 2-20299





PLASTIC FUEL TANKS & FITTINGS



PLASTIC PORTABLE FUEL TANKS

- Supplied with filler cap with air vent, 8mm hose connection and dip tube
- Moulded sight gauge on 2-20101, 2-20111 and 2-20112
- Vertical or Horizontal operating position on 2-20100 and 2-20101
- Conforms to RINA/CE regulations



*Optional filler cap with gauge and vent can be fitted to these portable fuel tanks. Part No. 2-20102



Part No.	Ltrs	Sight Gauge	H (mm)	W(mm)	L(mm)	Function
2-20100	12	No	420	260	200	Vertical or Horizontal
2-20101	24	Yes	505	330	230	Vertical or Horizontal*
2-20110	12	No	400	280	170	Horizontal
2-20111	24	Yes	460	340	230	Horizontal*
2-20112	29	Yes	510	365	230	Horizontal*



JERRY CANS

Part No.	Ltrs	H (mm)	W(mm)	L(mm)
2-20120	8	180	220	445
2-20121	15	250	220	445
2-20122	22	345	220	445



JERRY CAN DIP TUBE ADAPTOR KIT (8mm)

Can be added to 2-20120, 2-20121 & 2-20122
Part No. 2-20126



JERRY CAN FLEXIBLE POURING TUBE

Extends from 30 to 80cm
Part No. 2-20125

SPARE CAPS



PORTABLE FUEL TANKS
Part No. 12-20100-3



FIXED TANKS 1/2" BSP
Part No. 12-20200-3



JERRY CANS 1/2" BSP
Part No. 12-20120-3

45 DEGREE SWIVEL POURING SPOUT

For Jerry Cans
1/2" BSP
Part No. 2-20127



SECTION 1

MARINE FUEL HOSE EN ISO 7840 (10m)

1-57801 8mm ID ISO 7840 A1
1-57802 10mm ID ISO 7840 A1
1-57808 38mm ID ISO 7840 A2



2-76970

CAN-SB INLINE FILTERS

CAN-SB Inline Petrol Filter 2000cc 8mm hose
CAN-SB Inline Diesel Filter 2000cc 8mm hose

Part No. 2-76970

Part No. 2-76973



2-76973



9-96999

PLASTIC TANK BRACKETS

Consists of four brackets, four 120cm straps and two buckles.
Part No. 9-96999

LARGER SIZES AVAILABLE TO ORDER



FIXED PLASTIC FUEL TANKS & FITTINGS

FIXED PLASTIC FUEL TANKS

- Can be used for petrol or diesel fuel
- Made of high density polythene plastic suitable for acids and fuels
- Conforms to RINA/CE and ISO 21487

LOW PROFILE

- 200mm high x 290mm wide

Part No.	Litres	L (mm)	Sender
2-20000	28	450	4-47502 or 4-47442
2-20002	41	650	4-47502 or 4-47442
2-20004	54	850	4-47502 or 4-47442
2-20006	67	1050	4-47502 or 4-47442



MEDIUM PROFILE

Part No.	Litres	L (mm)	W (mm)	H (mm)	Senders
2-20010	43	450	390	290	4-47506 or 4-47442
2-20012	63	650	390	290	4-47506 or 4-47442
2-20014	83	850	390	290	4-47506 or 4-47442
2-20016	103	1050	390	290	4-47506 or 4-47442
2-20030	33	500	350	230	4-47503 or 4-47442
2-20031	43	650	350	230	4-47503 or 4-47442
2-20032	53	800	350	230	4-47503 or 4-47442



HIGH PROFILE

Part No.	Litres	L (mm)	W (mm)	H (mm)	Senders
2-20033	42	500	350	300	4-47506 or 4-47442
2-20034	55	650	350	300	4-47506 or 4-47442
2-20035	70	800	350	300	4-47506 or 4-47442
2-20036	102	800	400	400	4-47508 or 4-47442
2-20037	120	950	400	400	4-47508 or 4-47442
2-20038	140	1100	400	400	4-47508 or 4-47442
2-20040	62	660	300	410	4-47509 or 4-47442
2-20041	91	910	300	410	4-47509 or 4-47442
2-20045	62	660	410	300	4-47506 or 4-47442
2-20046	91	910	410	300	4-47506 or 4-47442



Supplied with a standard porthole connection plate incorporating:

1. 1/2" BSP Filler Cap with air vent - see page 40
(Optional use of 2-20200 & 2-20201 - see below)
2. 1/4" BSPF spare blanked connection (for diesel return or second fuel outlet for second engine)
3. Removeable sender cover plate to take five hole fixing flange mount sender (optional - see below or page 43)
4. Fuel Outlet for 10mm ID hose connection
5. 16mm connector for vent pipe

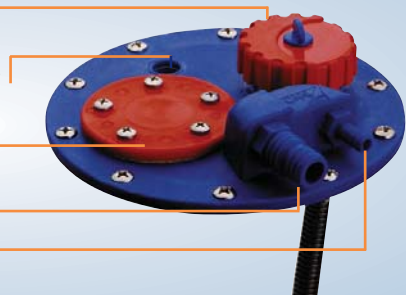

INLET FITTINGS

STRAIGHT PLASTIC
1/4" BSP 10mm hose
Part No. 2-20206



90° CHROMED BRASS
1/4" BSP 10mm hose
Part No. 2-20207



90° PLASTIC SWIVEL HOSE CONNECOR



FILLER PIPE KIT

90° elbow and 38/50/60mm ID hose connector
1 1/2" BSP



LEVER FUEL TANK SENDER WITH GAUGE

Part No.	Min Tank Height
2-22160	230mm
2-22161	280mm
2-22162	300mm
2-22163	410mm



SEE PAGE 43 FOR ELECTRIC TANK SENDERS & GAUGES

PLEASE NOTE: WITH ALL TANKS CHECK STOCK AVAILABILITY

Due to multitude of size and type options and space required to store not all models may be in stock



TANK VENTS & MISCELLANEOUS

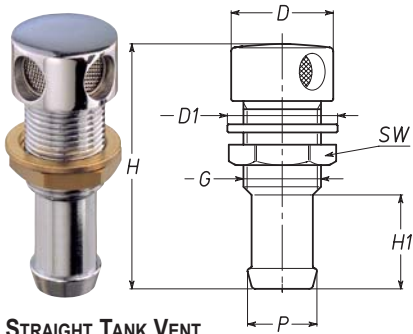

STRAIGHT TANK VENT



2-74506 (UP)

2-74505 (DOWN)

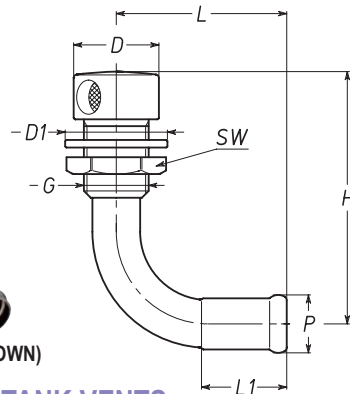

FLUSH TANK VENT

STRAIGHT TANK VENTS

- Choice of raised or flush tank vent
- Securely fixed S/S 400 micron flame proof gauze
- Polished brass or chrome plated brass

Type	Hose ID	G	H	H1	D	D1	P	Finish	Part No.
Raised	16 (5/8")	19x19 F	60	23	25	27	16	Chrome	2-74500
Raised	19 (3/4")	3/4"	70	25	32	38	20	Chrome	2-74510
Raised	19 (3/4")	3/4"	70	25	32	38	20	Brass	2-74511

90° TANK VENTS

- Choice of raised or flush tank vent
- Securely fixed S/S 400 micron flame proof gauze
- Chrome plated brass

Type	Hose ID	G	L	L1	D	D1	H	P	Pipe	Part No.
Raised	16 (5/8")	19x19 F	52	20	25	27	77	16	Down	2-74505
Raised	16 (5/8")	19x19 F	52	20	25	27	77	16	Up	2-74506
Flush	16 (5/8")	19x19 F	52	21	-	-	68	16	Down	2-74503

BRASS TANK VENTS



- Tank vent with flame trap
- 30mm Dia.
- 2-74509 fits S-13036 Dolly

Thread	Height OA	Shape	Finish	Part No.
1/2" BSP	47	Hexagonal	Brass	2-74508
1/2" BSP	47	Hexagonal	Chrome	2-74508C
1/2" BSP	27	Round	Brass	2-74509

SEMI FLUSH TANK VENT

- Vents with anti flame mesh
- Material: Brass

Hose Size	Height OA	Finish	Part No.
16mm	53mm	Chrome	2-74516
19mm	55mm	Chrome	2-74519



DRAIN PLUG

Brass bodied with removeable plug type cap.

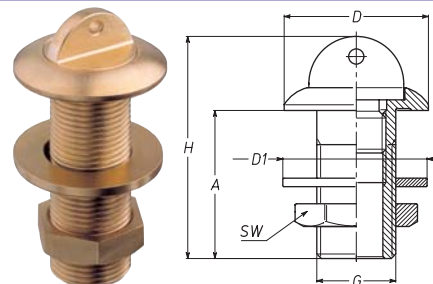

G*Thread	H	A	D	Part No.
1/2" BSP	58	40	38	2-74581
3/4" BSP	86	66	48	2-74582

CAPTIVE DINGHY DRAIN PLUG & SOCKET

Chromed Brass with captive washered plug. 3 x c/sunk m/screw attaching inner flange to outer. Fits 10mm thick hull. OA Dia. 55mm 17mm internal aperture
Part No. 2-74585 (Loose) or Part No. 2-74585P (Carded)



OUTBOARD WELL DRAIN

A corrosion proof, easy-to-install replacement for the old fashioned brass fitting. Can also be used as a chafe guard to lead hose, wiring, steering cables etc. through bulkheads, floor timbers and fibreglass panels. Barbs on OD insure positive locking action. Designed to fit 1" (25.14mm) hole. Flange: 1 1/4" (31.75mm) Useable length: 2 1/2" (63.5mm)
Part No. 2-80540



DRAIN PLUG

Moulded from Forespar's Marelon® and fitted with a neoprene seal, it is designed to not deteriorate and crack with age.
Part No. 2-80600

SHELL VENT/SCUPPER

- Chrome plated Brass
- With or without heavy S/S gauze
- Supplied with back nut

G*/BSP	SW	H	A	D	F	With Gauze	Without Gauze
1/2"	26	83	65	33	15	2-74451	2-74401
3/4"	32	88	68	38	19	2-74452	2-74402
1"	38	98	75	48	25	2-74453	2-74403
1 1/2"	49	106	80	55	33	2-74454	2-74404
1 1/2"	56	116	85	64	39	2-74455	2-74405
2"	68	124	90	77	50	2-74456	2-74406

G* Thread: ISO 228/1 (BS 2779) (DIN 259)



TANK SENDERS & GAUGES

WEMA-SYSTEM™ FUEL & WATER TANK GAUGES



Wema Fuel Level Gauge
Black 12/24V
Part No. 4-47550



Wema Fuel Level Gauge
White 12/24V
Part No. 4-47551



Wema Water Level Gauge
Black 12/24V
Part No. 4-47552



Wema Water Level Gauge
White 12/24V
Part No. 4-47553

FUEL & WATER TANK SENDERS

Part No.	Description
4-47501	Wema S/S Fuel/Water Sender 150mm
4-47502	Wema S/S Fuel/Water Sender 175mm
4-47503	Wema S/S Fuel/Water Sender 200mm
4-47504	Wema S/S Fuel/Water Sender 225mm
4-47505	Wema S/S Fuel/Water Sender 250mm
4-47506	Wema S/S Fuel/Water Sender 275mm
4-47507	Wema S/S Fuel/Water Sender 300mm
4-47508	Wema S/S Fuel/Water Sender 350mm
4-47509	Wema S/S Fuel/Water Sender 400mm
4-47510	Wema S/S Fuel/Water Sender 450mm
4-47511	Wema S/S Fuel/Water Sender 500mm
4-47512	Wema S/S Fuel/Water Sender 550mm
4-47513	Wema S/S Fuel/Water Sender 600mm

Wema Senders will operate with Uflex gauges

- 4-47231 Water Level Gauge Ultra Black
- 4-47331 Water Level Gauge Ultra White
- 4-47230 Fuel Level Gauge Ultra Black
- 4-47330 Fuel Level Gauge Ultra White



5 Hole Flange Mount Fitting

See Section 4 for more Uflex Gauges & Senders

UFLEX ADJUSTABLE FUEL LEVEL SENDER

- 20-60cm
- Single Station

Part No. 4-47442



WEMA-SYSTEM™ BLACK WATER TANK SENDERS & GAUGES

Part No.	Description
4-47520	Waste Tank Sender 100mm long 1¼" BSP
4-47521	Waste Tank Sender 205mm long 1¼" BSP
4-47522	Waste Tank Sender 305mm long 1¼" BSP
4-47523	Waste Tank Sender 410mm long 1¼" BSP
4-47554	Wema Holding Tank Indicator - Black
4-47555	Wema Holding Tank Indicator - White



4-47554



4-47555



4-47520/1/2/3

UFLEX FUEL LEVEL GAUGES



Ultra Black Part No. 4-47230



Ultra White Part No. 4-47330

CAN-SB BLACK WATER TANK SENSOR SWITCH 1" BSP

Part No. 9-97152



CAN-SB WARNING LIGHTS

- Part No. 9-97198 Red warning light 12/24V
- Part No. 9-97199 Green warning light 12/24V

WASTE TANK SENDER ADAPTER 1¼" BSP



Note: Use a 44mm dia. hole saw to cut sender opening and 5mm drill to fix the sender adapter to the tank.

Part No. 4-47524





We offer over 14,000 quality marine and industrial products from all around the world.

Our range can be viewed online at www.aquafax.co.uk or in the Aquafax printed catalogues.

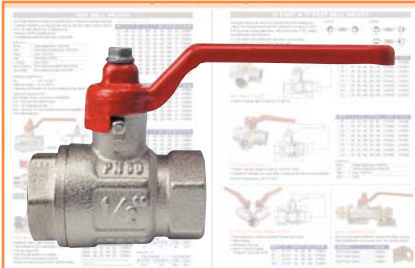

**Valves, Pipe Fittings,
Gas Equipment, Hose & Clips**



Hull & Engine Room Fittings



**Bow & Stern Thrusters
& Trim Tabs**



**Ultraflex Controls, Steering
& Compasses**



**Paints, Sealants
& Consumables**



**General Boat Equipment
and Accessories**



**Cabin Fittings, Hinges,
Padlocks, & General Hardware**



**Electrical - Batteries, Cables,
Terminals, Chargers & Inverters**



**Calorifiers, Toilets, Pumps,
Taps, Sinks & Fittings**



**Johnson Pump - Engine Cooling,
Bilge, Deckwash & Macerators**



**Mastervolt Electricals -
Complete Systems**



Narrowboat Equipment